

OVER 60?

Secure this property
for up to **59% less!**



Price

£190,000

Leasehold

2x  1x  1x 

Willow Court, St. Peter's Park Road,
Broadstairs, Kent, CT10

Wards
Helping you move forwards



Main features

- No forward chain
- Central Broadstairs location
- Perfect first time purchase or buy to let investment
- Within a stones throw from Broadstairs train station
- Good sized living area with your own private balcony

Accommodation

FIRST FLOOR

Entrance Hallway

Lounge: 16'8 x 15'4 (5.08m x 4.68m)

Kitchen: 8'4 x 6'5 (2.54m x 1.96m)

Bedroom 2: 13'10 x 10'7 (4.22m x 3.23m)

Bedroom 1: 14'3 x 9'8 (4.35m x 2.95m)

Bathroom

OUTSIDE

Balcony

Communal parking

First Floor

Approx. 64.4 sq. metres (693.7 sq. feet)

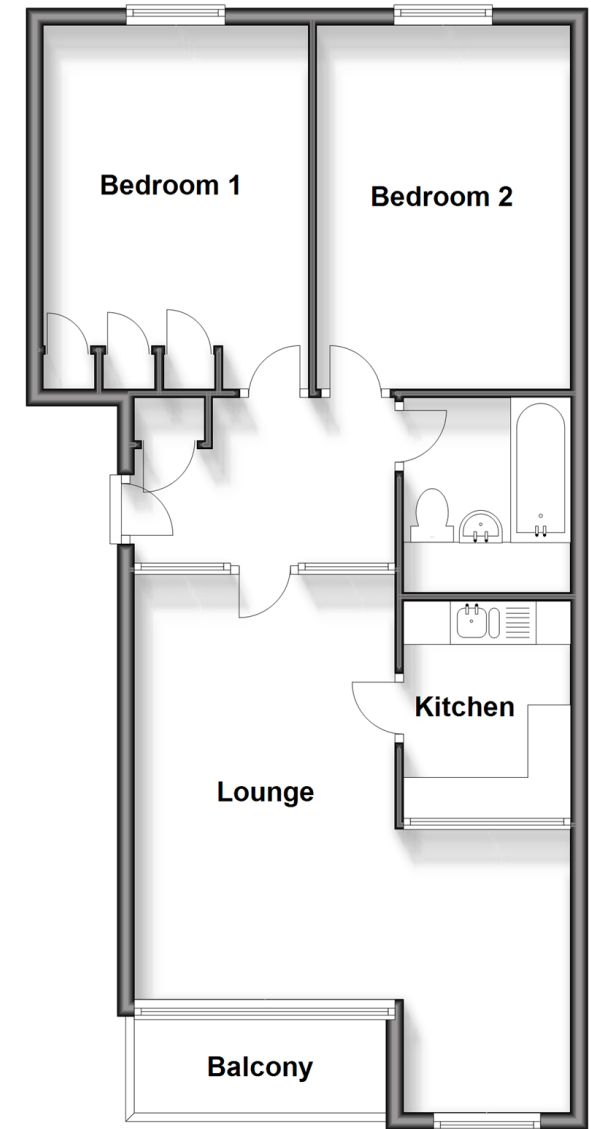

Call Broadstairs - 01843 602546 ■ wardsofkent.co.uk

- A private rental licensing scheme applies to some properties in this area, please contact us before proceeding
- Legal advice should be taken to verify fixtures/fittings, planning, alterations and/or lease details
- Appliances & services are untested, dimensions are approximate and floor plans are not to scale
- Through a Homewise Home For Life Plan people aged 60+ can secure this property for up to 59% less, by purchasing a Lifetime Lease.

