



**Price**

**£180,000**

**Leasehold**

2x  1x  1x 

**Tower View, Chartham  
Downs, Canterbury,  
Kent, CT4**

**OVER 60?**

Secure this property  
for up to **59% less!**

*Wards*  
Helping you move forwards





## Main features

- Top floor apartment offered with no onward chain
- Allocated parking space
- Sought after village location
- Security telephone entry system
- Residents only communal gym within the development

## Accommodation

### SECOND FLOOR

#### Entrance Hallway

Lounge/Diner: 11'2 x 10'6 (3.41m x 3.20m)

Kitchen: 9'8 x 8'0 (2.95m x 2.44m)

Bedroom 1: 10'7 x 10'6 (3.23m x 3.20m)

Bedroom 2: 10'2 x 9'5 (3.10m x 2.87m)

#### Bathroom

### OUTSIDE

#### Allocated Parking

## Second Floor

Approx. 58.5 sq. metres (629.2 sq. feet)

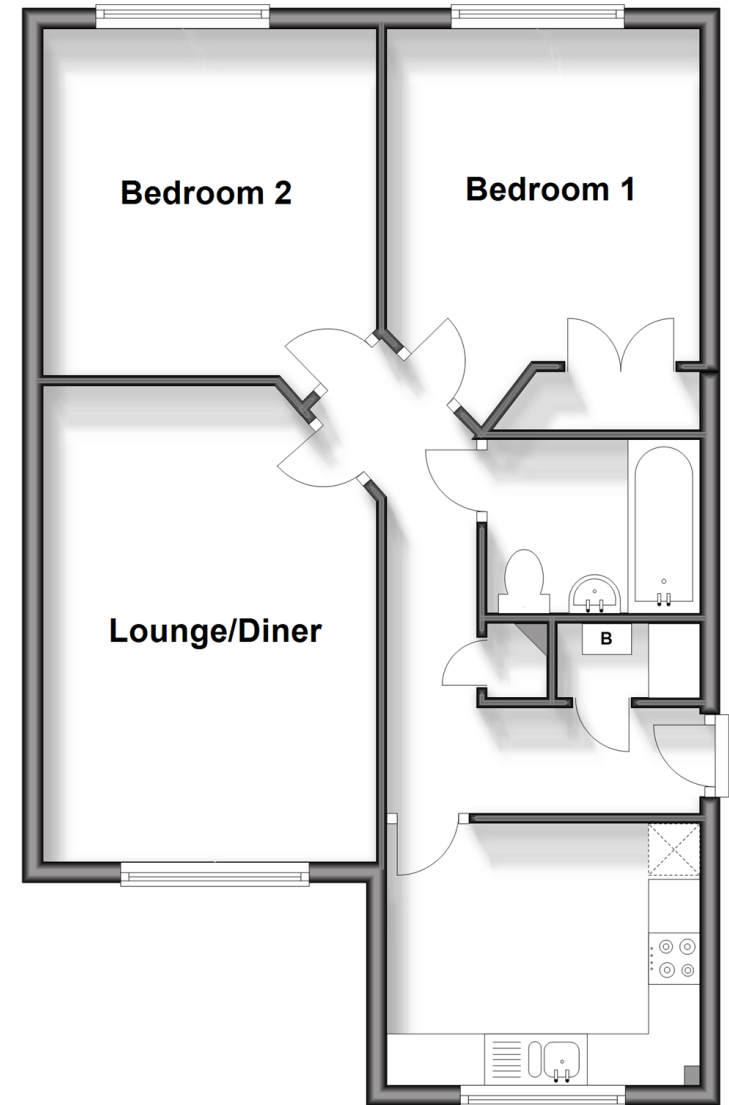

**Call Canterbury - 01227 766669 ■ [wardsofkent.co.uk](http://wardsofkent.co.uk)**

- Legal advice should be taken to verify fixtures/fittings, planning, alterations and/or lease details
- Appliances & services are untested, dimensions are approximate and floor plans are not to scale
- Through a Homewise Home For Life Plan people aged 60+ can secure this property for up to 59% less, by purchasing a Lifetime Lease.



10343590/20240314/TG/MWI