



Price
£375,000

Freehold

3x  1x  1x 

**Church Road,
Littlebourne,
Canterbury, Kent, CT3**

OVER 60?

Secure this property
for up to **59% less!**

Wards
Helping you move forwards



Main features

- Immaculately presented
- Driveway parking plus a garage to the rear
- Recently landscaped rear garden
- Sought after Littlebourne village, with popular pubs, primary school and recreation ground close by
- A stylish retirement option but also ideal for families

Accommodation

GROUND FLOOR

Entrance Hallway

Bedroom 1: 11'5 x 10'5 (3.48m x 3.18m)

Bedroom 2: 11'7 x 8'4 (3.53m x 2.54m)

Bedroom 3: 8'6 x 7'2 (2.59m x 2.19m)

Shower Room: 10'2 x 5'0 (3.10m x 1.53m)

Lounge: 14'2 x 12'4 (4.32m x 3.76m)

Kitchen: 10'6 x 8'4 (3.20m x 2.54m)

Dining Room: 16'5 x 6'3 (5.01m x 1.91m)

OUTSIDE

Front Garden

Driveway Parking

Rear Garden

Garage

Ground Floor

Approx. 79.8 sq. metres (858.9 sq. feet)

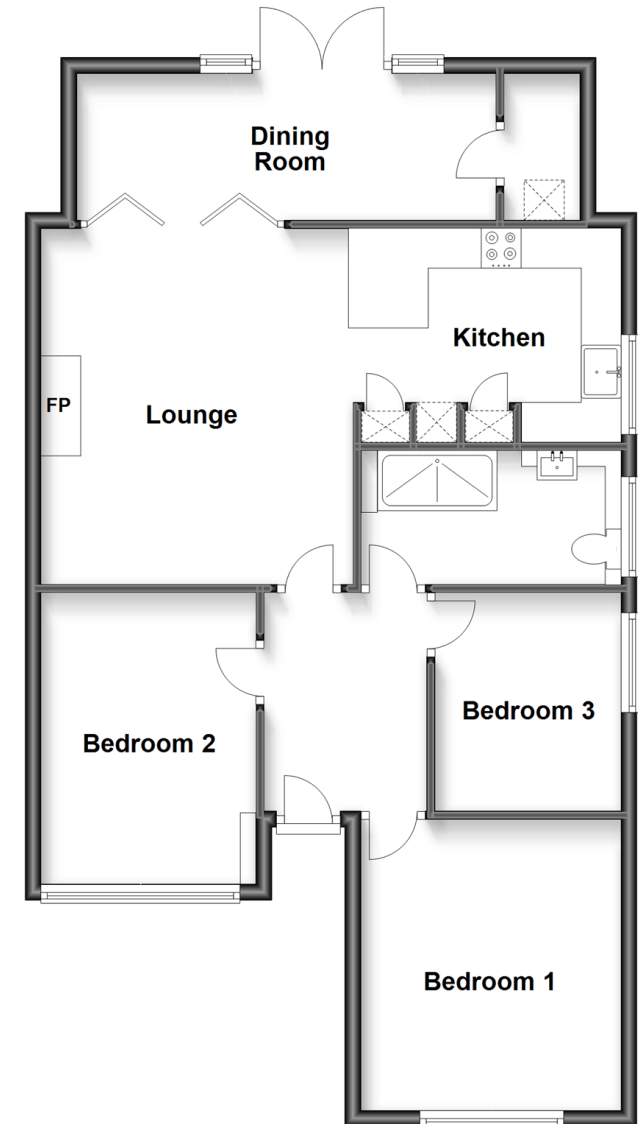

Call Canterbury - 01227 766669 ■ wardsofkent.co.uk

- Legal advice should be taken to verify fixtures/fittings, planning, alterations and/or lease details
- Appliances & services are untested, dimensions are approximate and floor plans are not to scale
- Through a Homewise Home For Life Plan people aged 60+ can secure this property for up to 59% less, by purchasing a Lifetime Lease.



10348065/20230802/TG/AH