



Price

£530,000

Freehold

4x  2x  2x 

The Harrogate, Canterbury, Kent, CT3 4FL

Wards
Helping you move forwards

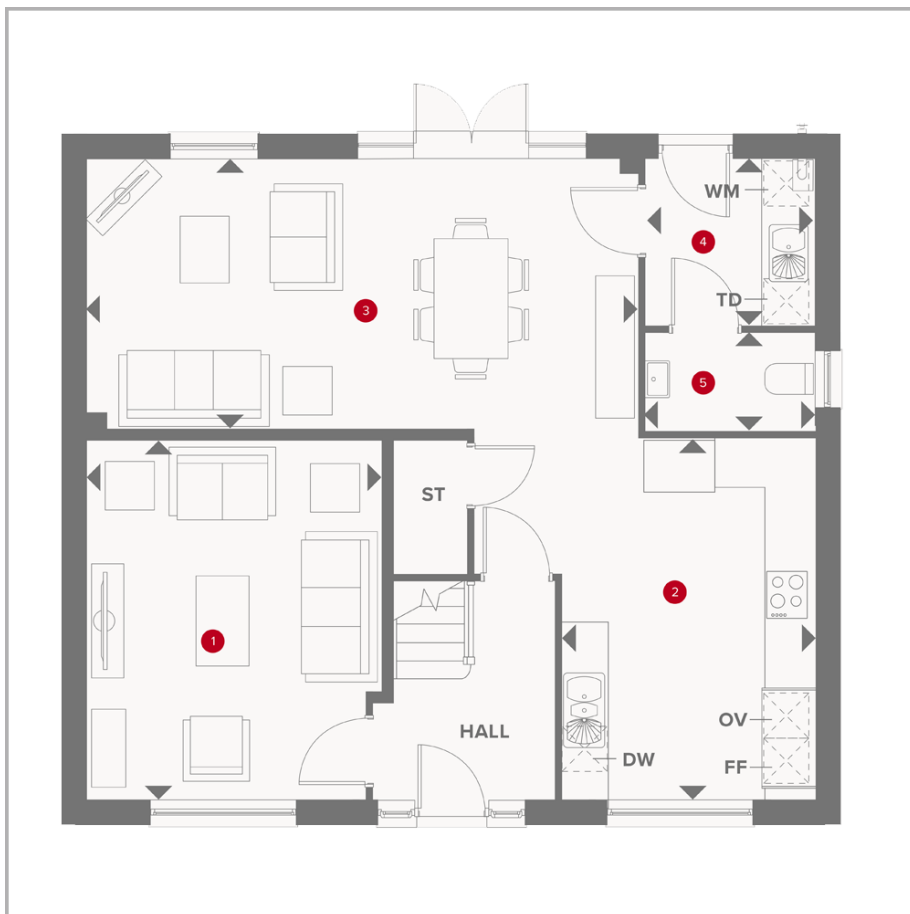

Accommodation

GROUND FLOOR

Lounge: 14'6 x 12'0 (4.42m x 3.66m)

Kitchen: 14'6 x 10'4 (4.42m x 3.15m)

Family/Dining: 22'5 x 10'11 (6.84m x 3.33m)

Cloakroom

Utility Room: 6'9 x 6'8 (2.06m x 2.03m)

Hallway

Bedroom 2: 13'7 x 10'4 (4.14m x 3.15m)

Bedroom 3: 12'1 x 10'4 (3.69m x 3.15m)

Bedroom 4: 11'2 x 9'6 (3.41m x 2.90m)

Bathroom

OUTSIDE

Garage

Rear Garden

FIRST FLOOR

Landing

Bedroom 1: 12'2 x 10'4 (3.71m x 3.15m)

En suite



Main features

- Detached new build house
- Open plan kitchen/diner with utility room
- Contemporary kitchen exclusive to Redrow with high end integrated appliances
- En suite to bedroom 1 with modern white sanitaryware and chrome fittings
- Integral garage and off-road parking



Nearest Schools

Primary Schools: Kemsley Primary 18. miles, Milton Court Primary 18. miles, Regis Manor Community Primary 18. miles

Secondary Schools: Borden Grammar School 18. miles,



Transport Information

Train Stations: Newington 21. miles, Rainham 23. miles, Gillingham 26. miles



Address

The Harrogate, Canterbury, Kent, CT3 4FL



Directions

For directions to this property please contact us.



Wards
Helping you move forwards

Call Canterbury Branch 01227 766669 ■ wardsofkent.co.uk



■ If buying to let, the energy rating will need to be improved to at least 'E' rating before you can let the property
■ Appliances & services are untested, dimensions are approximate and floor plans are not to scale

■ Legal advice should be taken to verify fixtures/fittings, planning, alterations and/or lease details

10348665/20240417/TG/JT