



**Price**  
**£210,000**

**Freehold**

2x  1x  2x 

**Whitehorse Hill,  
Chatham, Kent, ME5**

**OVER 60?**

Secure this property  
for up to **59% less!**

*Wards*  
Helping you move forwards



## Main features

- Victorian terrace house in great condition
- Separate lounge and dining room, separate upstairs bathroom.
- Low maintenance rear garden
- Excellent choice for a first time/investment buy
- Great location for town centre and local schools

## Accommodation

### GROUND FLOOR

Entrance Hall

Lounge : 9'10 x 8'11 (3.00m x 2.72m)

Dining Room : 12'4 x 10'4 (3.76m x 3.15m)

Kitchen: 9'2 x 6'10 (2.80m x 2.08m)

### SPLIT LEVEL FIRST FLOOR

Landing

Bedroom 1: 12'1 x 9'10 (3.69m x 3.00m)

Bedroom 2: 10'3 x 9'2 (3.13m x 2.80m)

Bathroom

### OUTSIDE

Rear Garden

### Ground Floor

Approx. 33.0 sq. metres (354.9 sq. feet)

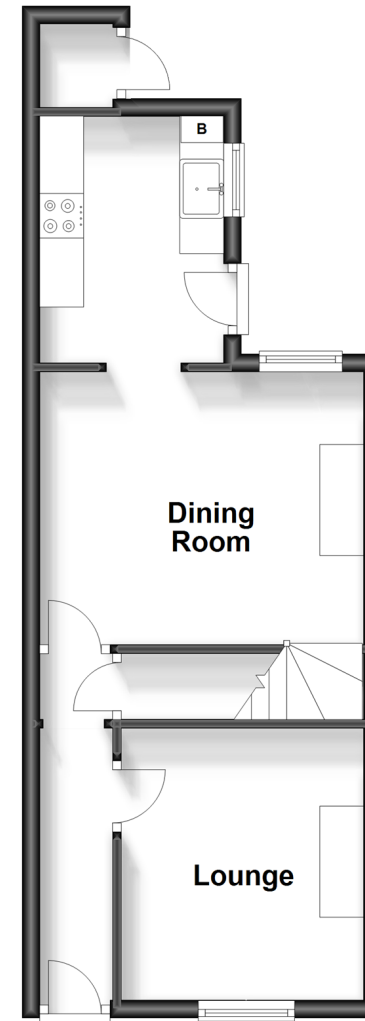

### Split Level First Floor

Approx. 32.1 sq. metres (345.7 sq. feet)



**Call Chatham - 01634 841243 ■ [wardsof Kent.co.uk](http://wardsof Kent.co.uk)**

- Legal advice should be taken to verify fixtures/fittings, planning, alterations and/or lease details
- Appliances & services are untested, dimensions are approximate and floor plans are not to scale
- Through a Homewise Home For Life Plan people aged 60+ can secure this property for up to 59% less, by purchasing a Lifetime Lease.



10435169/20231026/BC/BC