



Price
£240,000

Freehold

2x  1x  1x 

**Church Street, Eastry,
Sandwich, Kent, CT13**

Wards
Helping you move forwards



Main features

- Quiet, pretty location close to the heart of the village
- New windows, doors, carpets and kitchen added
- Immaculate condition, ready to move into
- Lots of character features including exposed brick walls, stripped floorboards and feature fireplaces
- Courtyard garden and a large separate private lawned garden

Accommodation

GROUND FLOOR

Lounge: 10'9 x 10'4 (3.28m x 3.15m)

Kitchen : 10'11 x 9'2 (3.33m x 2.80m)

Shower Room

FIRST FLOOR

Bedroom 1: 10'11 x 10'8 (3.33m x 3.25m)

Bedroom 2: 10'11 x 9'1 (3.33m x 2.77m)

OUTSIDE

Rear Courtyard

Rear Garden

Split Level Ground Floor

Approx. 27.3 sq. metres (293.7 sq. feet)



Split Level First Floor

Approx. 23.0 sq. metres (247.6 sq. feet)

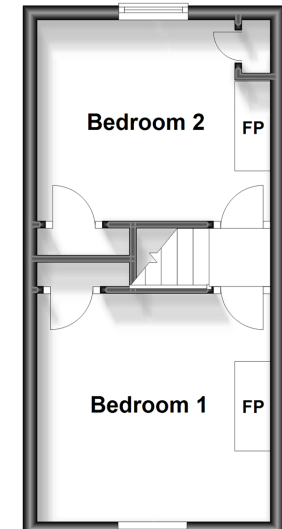

Call Deal - 01304 361420 ■ wardsofkent.co.uk

■ Legal advice should be taken to verify fixtures/fittings, planning, alterations and/or lease details

■ Appliances & services are untested, dimensions are approximate and floor plans are not to scale



10634748/20230724/LB1/LB1