



OVER 60?

Secure this property
for up to **59% less!**

Price
£575,000

Freehold

3x  2x  2x 

**Upper Street,
Kingsdown, Deal, Kent,
CT14**

Wards
Helping you move forwards

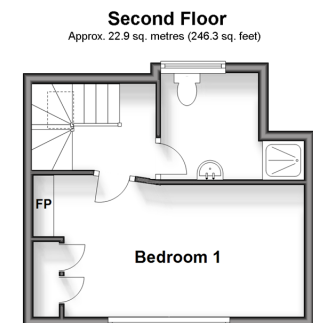
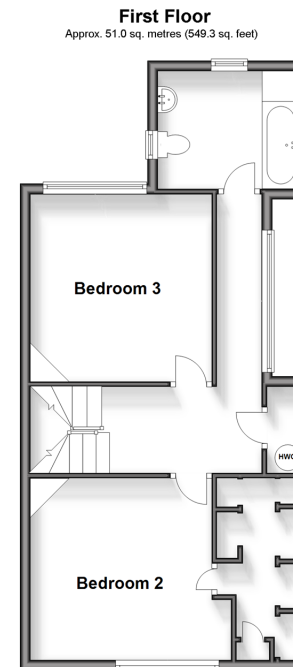
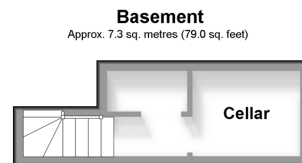
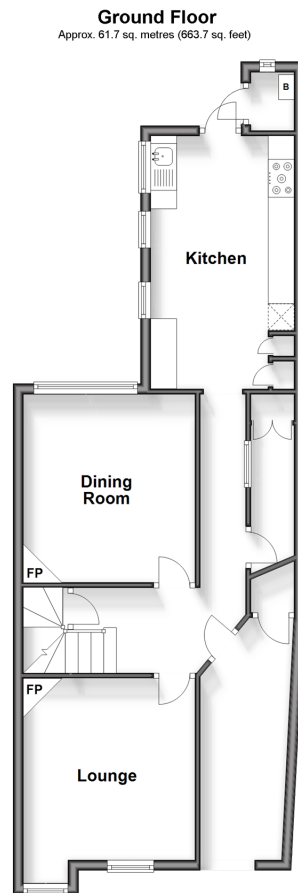

Accommodation

GROUND FLOOR

Entrance Hallway

Lounge : 11'7 x 10'10 (3.53m x 3.30m)

Dining Room: 12'3 x 11'3 (3.74m x 3.43m)

Kitchen : 15'11 x 9'0 (4.85m x 2.75m)

BASEMENT

Cellar : 10'0 x 5'5 (3.05m x 1.65m)

FIRST FLOOR

Landing

Bedroom 2: 12'8 x 11'8 (3.86m x 3.56m)

Walk in Wardrobe

Bedroom 3: 11'10 x 11'2 (3.61m x 3.41m)

Bathroom

SECOND FLOOR

Landing

Bedroom 1: 16'9 x 8'3 (5.11m x 2.52m)

Shower Room

OUTSIDE

Rear Garden



Main features

- Generous garden to the rear
- Comes with character features and a useful basement room
- Period property within moments of the seafront
- In excellent condition throughout with granite worktops and under floor heating
- Situated in a desirable location with amenities nearby



Nearest Schools

Primary Schools: Kingsdown and Ringwould CofE Primary 0.3 miles, Deal Parochial C of E Primary 2.3 miles, The Downs C of E Primary 2.5 miles

Secondary Schools: Learning Opportunities Centre



Transport Information

Train Stations: Walmer 2.0 miles, Martin Mill 3.1 miles, Deal 3.1 miles



Address

Upper Street, Kingsdown, Deal, Kent, CT14



Directions

For directions to this property please contact us.



Call Deal Branch 01304 361420 ■ wardsofkent.co.uk



- Legal advice should be taken to verify fixtures/fittings, planning, alterations and/or lease details
- Appliances & services are untested, dimensions are approximate and floor plans are not to scale
- Through a Homewise Home For Life Plan people aged 60+ can secure this property for up to 59% less, by purchasing a Lifetime Lease.



10634926/20240126/WSM/WSM