



Price
£265,000

Leasehold

2x  1x  1x 

**Shaftesbury Court, Lord
Warden Avenue,
Walmer, Deal, Kent,
CT14**

OVER 60?

Secure this property
for up to **59% less!**

Wards
Helping you move forwards



Main features

- Ground floor apartment with patio area
- Residents parking
- New windows, doors and boiler
- New shower room completed approximately 1.5 years ago and both bedroom ceilings re-plastered
- Situated on a well maintained estate with stunning gardens and only minutes from the beach

Accommodation

GROUND FLOOR

Entrance Hallway

Kitchen : 13'3 x 5'11 (4.04m x 1.80m)

Shower Room

Bedroom 2: 10'8 x 9'1 (3.25m x 2.77m)

Bedroom 1: 11'11 x 9'7 (3.63m x 2.92m)

Lounge/Diner : 16'6 x 16'1 (5.03m x 4.91m)

OUTSIDE

Communal Gardens

Residents Parking

Ground Floor

Approx. 58.3 sq. metres (628.0 sq. feet)

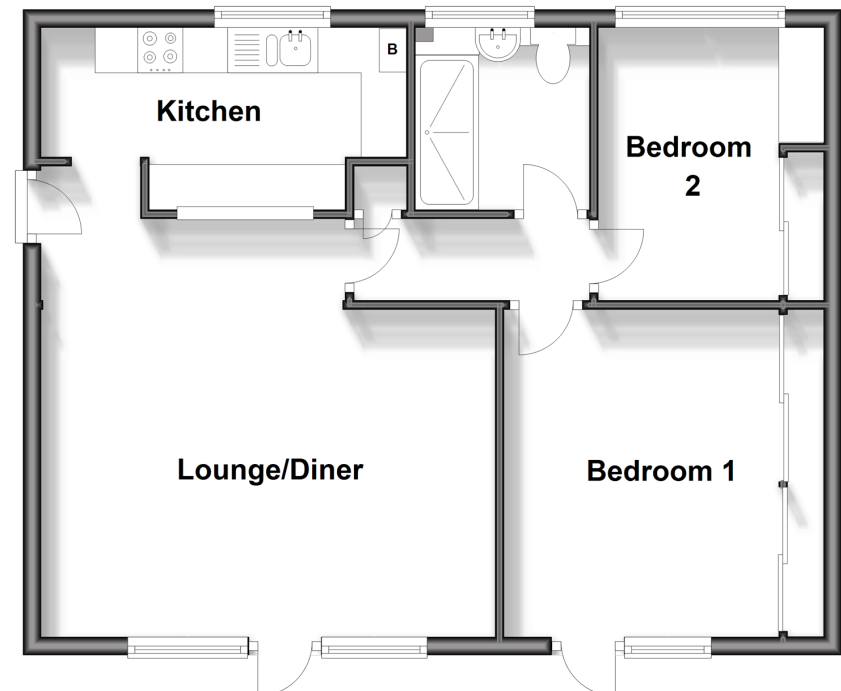

Call Deal - 01304 361420 ■ wardsofkent.co.uk

■ Legal advice should be taken to verify fixtures/fittings, planning, alterations and/or lease details
 ■ Through a Homewise Home For Life Plan people aged 60+ can secure this property for up to 59% less, by purchasing a Lifetime Lease.

■ Appliances & services are untested, dimensions are approximate and floor plans are not to scale



10634983/20240406/BG/LB1