

Guide Price
£250,000

Leasehold

3x  1x  1x 

**The Gateway, Dover,
Kent, CT16**

OVER 60?

Secure this property
for up to **59% less!**

Wards
Helping you move forwards



Main features

- Sought after sea views across the Channel
- No onward chain complications
- Lift to the apartment
- Walking distance to the town centre & local amenities
- Communal gardens, lockable storage cupboard & residence parking



Accommodation

EIGHT FLOOR

Entrance Hallway

Lounge/Diner : 19'4 x 10'6 (5.90m x 3.20m)

Kitchen : 12'1 x 10'1 (3.69m x 3.08m)

Balcony

Separate Cloakroom: 5'7 x 2'9 (1.70m x 0.84m)

Bathroom : 7'1 x 5'6 (2.16m x 1.68m)

Bedroom 1: 9'9 x 8'1 (2.97m x 2.47m)

Balcony

Bedroom 2 : 7'3 x 5'6 (2.21m x 1.68m)

Bedroom 3 : 11'6 x 9'3 (3.51m x 2.82m)

OUTSIDE

Communal Gardens

Residence Parking

Eighth Floor

Approx. 81.5 sq. metres (877.0 sq. feet)

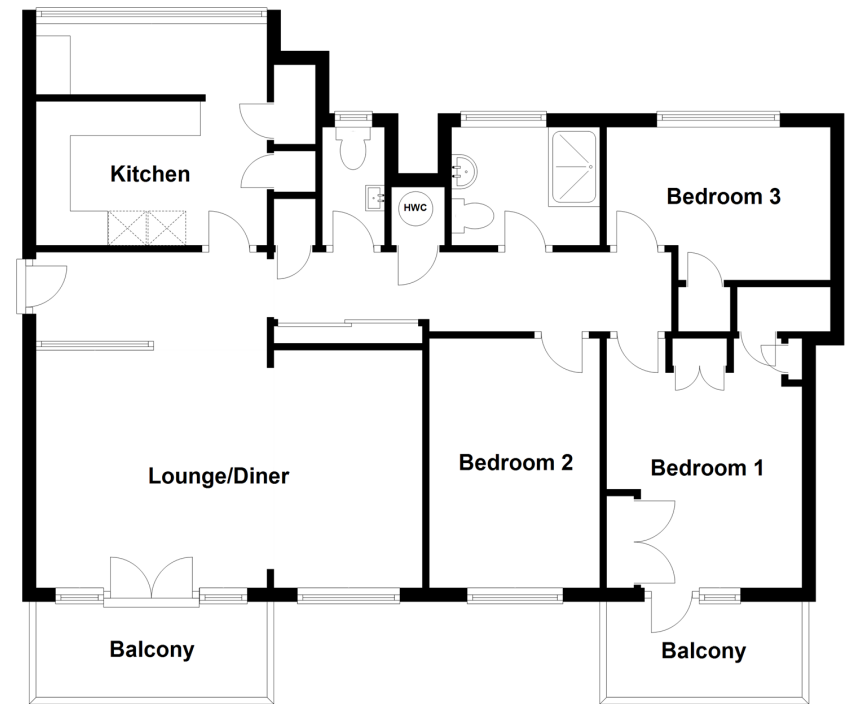

Call Dover - 01304 214876 ■ wardsofkent.co.uk

- Legal advice should be taken to verify fixtures/fittings, planning, alterations and/or lease details
- Appliances & services are untested, dimensions are approximate and floor plans are not to scale
- Through a Homewise Home For Life Plan people aged 60+ can secure this property for up to 59% less, by purchasing a Lifetime Lease.



10718177/20230817/GM/AF