



Price
£325,000

Freehold

3x  1x  2x 

**Cranleigh Drive,
Whitfield, Dover, Kent,
CT16**

OVER 60?

Secure this property
for up to **59% less!**

Wards
Helping you move forwards



Main features

- Ideal house for a family
- Spacious feel throughout the home with great views
- Off road parking & garage with power to the rear
- Great road links via the A2/M2 & A256
- Lovely village location, close to local shops, schools & amenities

Accommodation

GROUND FLOOR

Entrance Hall
 Lounge/Diner: 17'4 x 15'7 (5.29m x 4.75m)
 Kitchen : 9'3 x 8'11 (2.82m x 2.72m)
 Conservatory : 13'1 x 7'9 (3.99m x 2.36m)

FIRST FLOOR

Landing
 Bedroom 1 : 14'6 x 9'5 (4.42m x 2.87m)
 Bedroom 2 : 11'11 x 8'3 (3.63m x 2.52m)
 Bedroom 3 : 9'0 x 7'2 (2.75m x 2.19m)
 Bathroom

OUTSIDE

Front Garden
 Rear Garden
 Garage En-Bloc To The Rear

Ground Floor

Approx. 47.2 sq. metres (507.7 sq. feet)

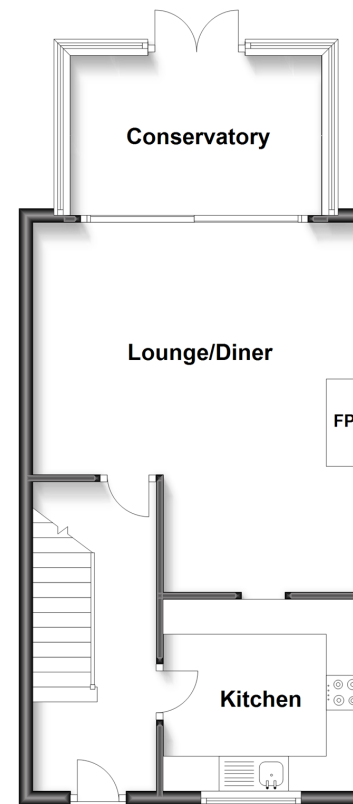

First Floor

Approx. 38.5 sq. metres (414.5 sq. feet)

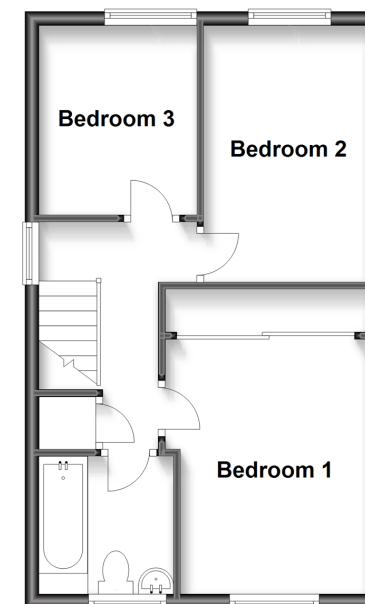

Call Dover - 01304 214876 ■ wardsofkent.co.uk

- Legal advice should be taken to verify fixtures/fittings, planning, alterations and/or lease details
- Appliances & services are untested, dimensions are approximate and floor plans are not to scale
- Through a Homewise Home For Life Plan people aged 60+ can secure this property for up to 59% less, by purchasing a Lifetime Lease.



10733772/20230522/TE/KW