



Price
£190,000

Freehold

2x  1x  1x 

**Wyndham Road, Dover,
Kent, CT17**

OVER 60?

Secure this property
for up to **59% less!**

Wards
Helping you move forwards



Main features

- Charming house
- Central location close to schools and shops
- Perfect investment or first time buy
- Low maintenance rear garden
- Fantastic access to the A2/M2, A20/M20 and high-speed rail links to London via Dover Priory

Accommodation

GROUND FLOOR

Entrance Porch

Kitchen: 8'9 x 5'8 (2.67m x 1.73m)

Lounge /Diner: 21'0 x 12'1 (6.41m x 3.69m)

FIRST FLOOR

Landing

Bathroom : 9'1 x 6'2 (2.77m x 1.88m)

Bedroom 1: 11'8 x 6'0 (3.56m x 1.83m)

Bedroom 2 : 8'8 x 8'8 (2.64m x 2.64m)

OUTSIDE

Front Garden

Rear Garden

Ground Floor

Approx. 28.6 sq. metres (308.1 sq. feet)

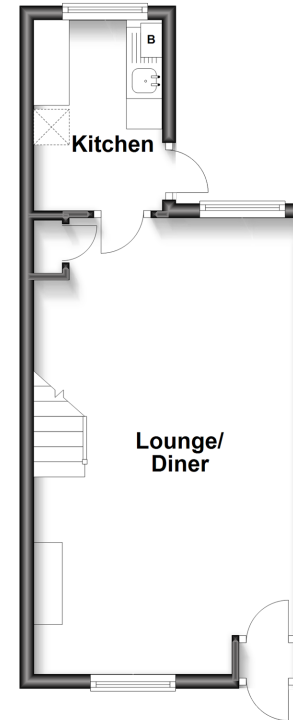

First Floor

Approx. 28.3 sq. metres (304.9 sq. feet)

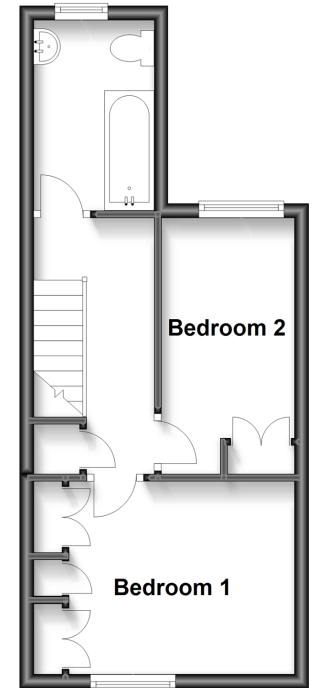

Call Dover - 01304 214876 ■ wardsofkent.co.uk

- Legal advice should be taken to verify fixtures/fittings, planning, alterations and/or lease details
- Appliances & services are untested, dimensions are approximate and floor plans are not to scale
- Through a Homewise Home For Life Plan people aged 60+ can secure this property for up to 59% less, by purchasing a Lifetime Lease.



10734239/20230107/TE/AF