



**Guide Price**  
**£100,000**

**Leasehold**

1x  1x  1x 

**Cameron Court,  
Churchill Road, Dover,  
Kent, CT17**

*Wards*  
Helping you move forwards





## Main features

- Ground floor apartment, set in sought after location
- Off road parking
- Sold with tenant in situ. Currently paying £700.00 per calendar month
- No onward chain complications
- Ideal property for a landlord to add to a current portfolio

## Accommodation

### GROUND FLOOR

Entrance Hallway

Bedroom : 12'2 x 8'10 (3.71m x 2.69m)

Bathroom

Kitchen/Lounge : 17'1 x 13'1 (5.21m x 3.99m)

### OUTSIDE

Off Road Parking

## Ground Floor

Approx. 40.9 sq. metres (440.5 sq. feet)

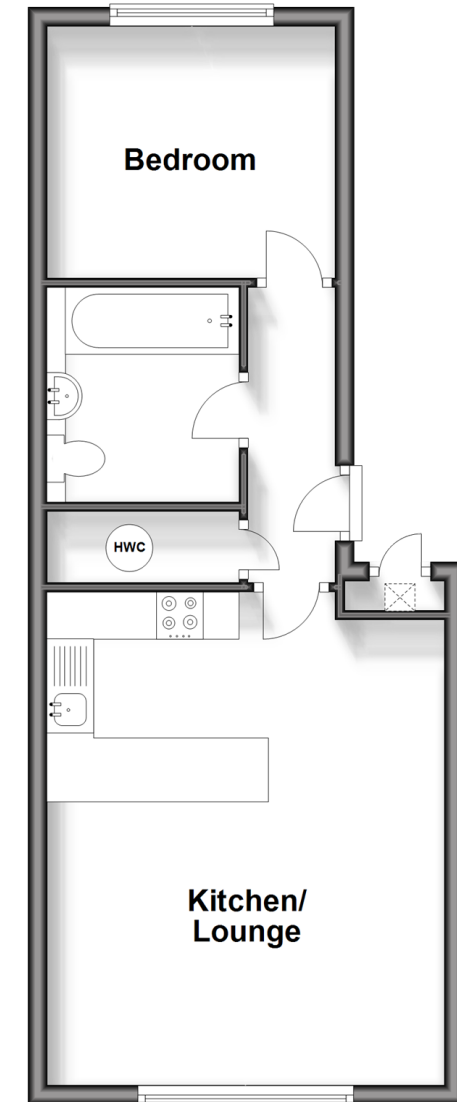

**Call Dover - 01304 214876 ■ [wardsof Kent.co.uk](http://wardsof Kent.co.uk)**

- Legal advice should be taken to verify fixtures/fittings, planning, alterations and/or lease details
- Appliances & services are untested, dimensions are approximate and floor plans are not to scale



10734794/20240422/TE/GM