



**Price**  
**£130,000**

**Leasehold**

1x  1x  1x 

**Lower Ground Floor  
Flat, Norman Street,  
Dover, Kent, CT17**

*Wards*  
Helping you move forwards





## Main features

- Stunning lower ground floor flat
- Located in the heart of Dover
- No onward chain complications, making this your own, sooner than you think
- Move in without lifting a finger
- Close to shops, schools and Dover Priory railway station

## Accommodation

### SPLIT LEVEL LOWER GROUND FLOOR

#### Entrance Hallway

Bedroom : 12'4 x 9'5 (3.76m x 2.87m)

Lounge : 19'8 x 10'5 (6.00m x 3.18m)

Kitchen : 9'8 x 5'7 (2.95m x 1.70m)

Shower Room: 5'4 x 5'1 (1.63m x 1.55m)

### OUTSIDE

Communal Gardens

## Split Level Lower Ground Floor

Approx. 40.0 sq. metres (430.9 sq. feet)

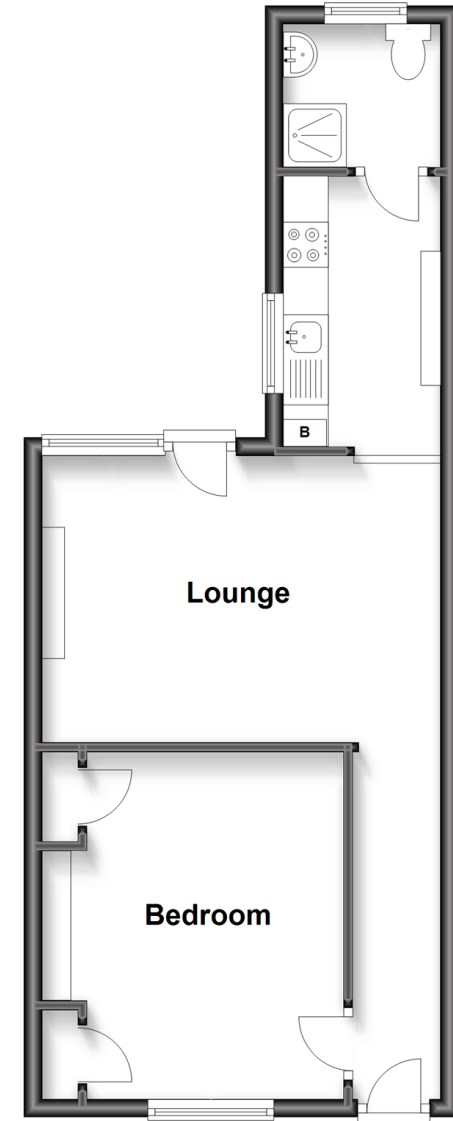

**Call Dover - 01304 214876 ■ [wardsof Kent.co.uk](http://wardsof Kent.co.uk)**

- Legal advice should be taken to verify fixtures/fittings, planning, alterations and/or lease details
- Appliances & services are untested, dimensions are approximate and floor plans are not to scale



10735073/20230808/TE/OV