



Price
£229,950

Freehold

2x  1x  2x 

**Mount Road, Dover,
Kent, CT17**

Wards
Helping you move forwards



Main features

- Sought after location
- Large enclosed rear garden, ideal for children or pets
- Sought after Maxton area of Dover
- Close proximity to Dover town centre and Dover Priory railway station with its fast links to London
- Ideal first time buy or buy to let investment

Accommodation

GROUND FLOOR

Lounge : 16'2 x 11'6 (4.93m x 3.51m)

Kitchen : 11'8 x 7'8 (3.56m x 2.34m)

Conservatory : 9'3 x 7'7 (2.82m x 2.31m)

Bedroom 1 : 11'3 x 11'2 (3.43m x 3.41m)

Bedroom 2 : 13'2 x 11'8 (4.02m x 3.56m)

Bathroom

OUTSIDE

Front Garden

Rear Garden

Ground Floor

Approx. 70.4 sq. metres (757.7 sq. feet)

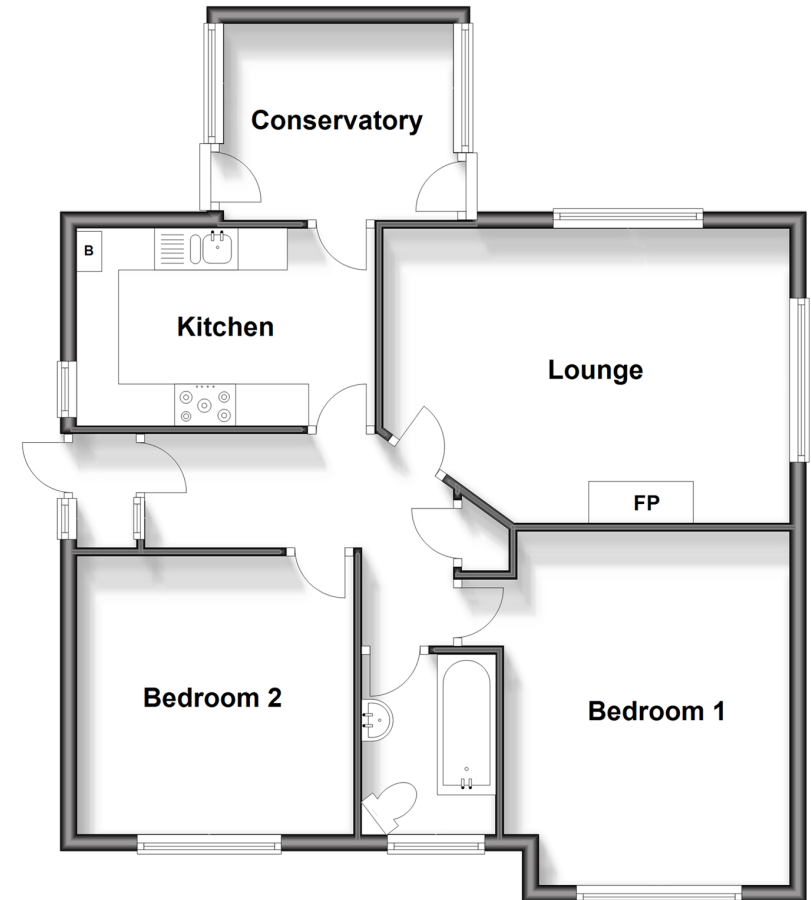

Call Dover - 01304 214876 ■ wardsofkent.co.uk

- Legal advice should be taken to verify fixtures/fittings, planning, alterations and/or lease details
- Appliances & services are untested, dimensions are approximate and floor plans are not to scale



10735412/20240417/GM/OV