



Price
£170,000

Leasehold

2x  1x  1x 

**Maxton Court,
Folkestone Road, Dover,
Kent, CT17**

OVER 60?

Secure this property
for up to **59% less!**

Wards
Helping you move forwards



Main features

- Large purpose built first floor apartment
- Off road parking and garage
- Sought after location of Maxton
- Ideal first time buy or potential for a buy to let
- Large bedrooms as well as a separate kitchen and lounge, space on offer needs to be seen

Accommodation

FIRST FLOOR

Entrance Hallway

Lounge : 17'4 x 10'4 (5.29m x 3.15m)

Bedroom 1 : 13'1 x 9'2 (3.99m x 2.80m)

Bathroom : 6'4 x 5'9 (1.93m x 1.75m)

Bedroom 2 : 9'8 x 9'2 (2.95m x 2.80m)

Kitchen: 14'7 x 7'2 (4.45m x 2.19m)

OUTSIDE

Off Road Parking
Garage

First Floor

Approx. 62.3 sq. metres (670.8 sq. feet)

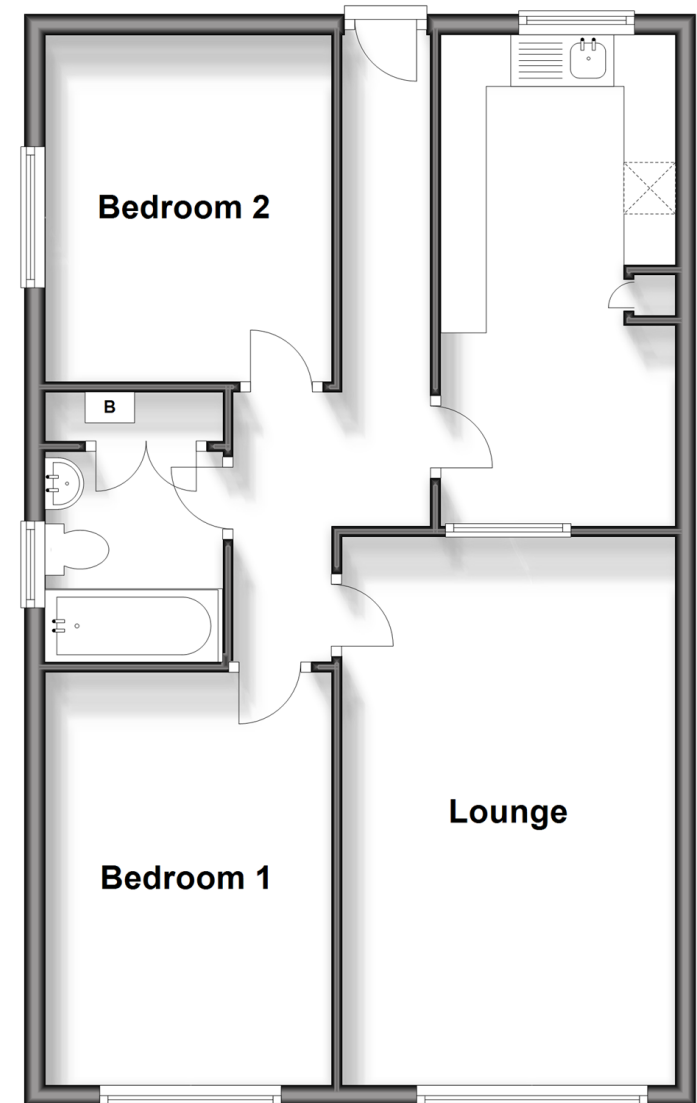

Call Dover - 01304 214876 ■ wardsofkent.co.uk

- Legal advice should be taken to verify fixtures/fittings, planning, alterations and/or lease details
- Appliances & services are untested, dimensions are approximate and floor plans are not to scale
- Through a Homewise Home For Life Plan people aged 60+ can secure this property for up to 59% less, by purchasing a Lifetime Lease.



10735486/20240313/TE/OV