

Price

£570,000

Freehold

4x  2x  2x 

**The Willow, Faversham
Lake, Ham Road,
Faversham Lakes,
Faversham, Kent, ME13**

Wards
Helping you move forwards



Main features

- **The Willow, an expansive 1385 sq. ft house set over two floors**
- **The ground floor features a spacious open plan kitchen/dining room with bi-fold doors**
- **Separate lounge perfect for socialising with the family and a private study.**
- **The Master bedroom is completed with an en-suite**
- **This home features two private parking spaces.**

Accommodation

GROUND FLOOR

Entrance Hall

Living Room: 16'7 x 12'3 (5.06m x 3.74m)

Study: 8'9 x 7'5 (2.67m x 2.26m)

Cloakroom

Kitchen/Dining Room: 18'10 x 11'10 (5.74m x 3.61m)

Utility/Boot Room: 6'0 x 5'11 (1.83m x 1.80m)

FIRST FLOOR

Landing

Master Bedroom: 14'5 x 12'3 (4.40m x 3.74m)

En-Suite Shower Room

Bedroom 2: 14'2 x 12'2 (4.32m x 3.71m)

Bedroom 3: 12'8 x 8'9 (3.86m x 2.67m)

Bedroom 4: 10'8 x 7'8 (3.25m x 2.34m)

Bathroom

OUTSIDE

Front & Rear Gardens

Parking for 2 cars

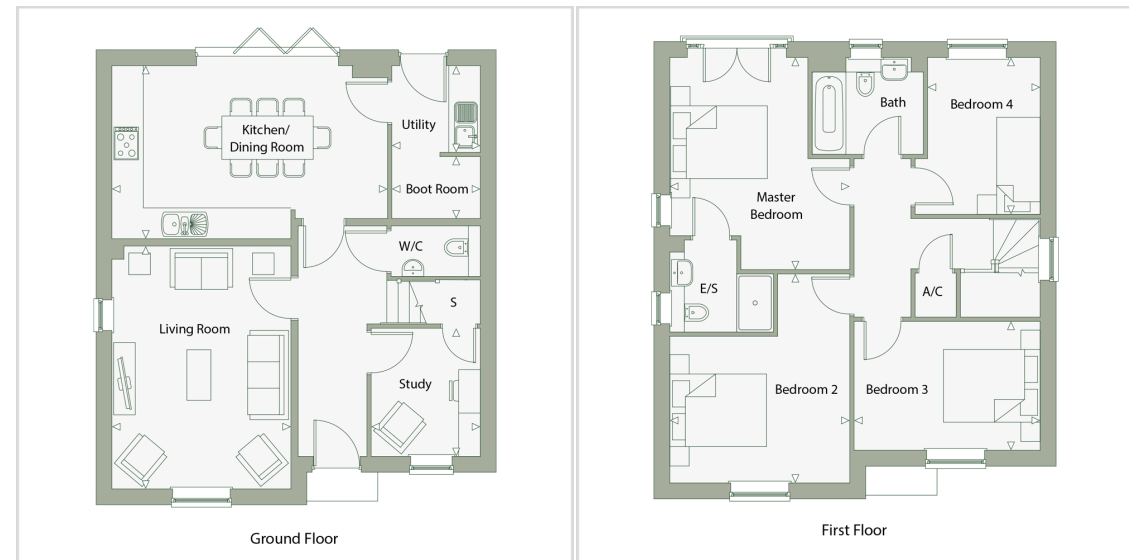

Call Faversham - 01795 535517 ■ wardsofkent.co.uk

■ If buying to let, the energy rating will need to be improved to at least 'E' rating before you can let the property

■ Appliances & services are untested, dimensions are approximate and floor plans are not to scale

■ Legal advice should be taken to verify fixtures/fittings, planning, alterations and/or lease details



10831602/20230705/HR/TM