



**Guide Price**  
**£400,000**

**Freehold**

2x  1x  2x 

**Court Street,  
Faversham, Kent, ME13**

**OVER 60?**

Secure this property  
for up to **59% less!**



**Video Tour available**

**Wards**  
Helping you move forwards

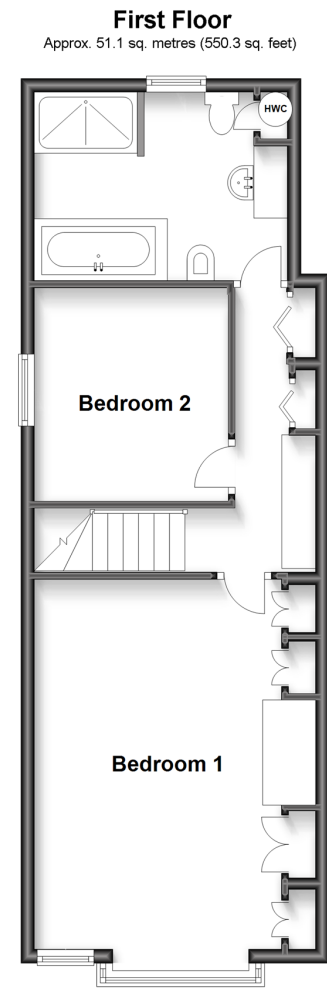
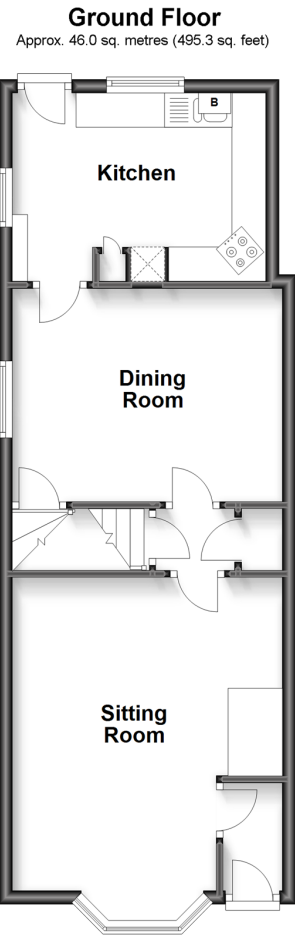
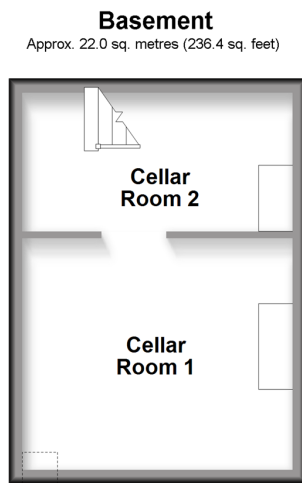

## Accommodation

### GROUND FLOOR

Entrance Lobby

Sitting Room: 14'10 (4.52m) narrowing to 9'11 at narrowest point (3.02m) x 13'0 (3.97m)

Dining Room: 13'8 x 10'2 (4.17m x 3.10m)

Kitchen: 12'8 x 8'10 (3.86m x 2.69m)

### BASEMENT

Cellar Room 1: 11'4 x 10'1 (3.46m x 3.08m)

Cellar Room 2: 12'8 x 6'5 (3.86m x 1.96m)

### FIRST FLOOR

Landing

Bedroom 1: 17'10 x 11'9 (5.44m x 3.58m)

Bedroom 2: 10'6 x 9'8 (3.20m x 2.95m)

Bathroom

### OUTSIDE

Walled Rear Garden

Outside Brick Store

Garden Shed





## Main features

- Charming Grade 2 listed house in prime town centre location
- Built circa 16th Century with many original features
- Lovely walled rear garden with many mature plants and shrubs
- Chain free allowing for quick completion
- Shops, supermarkets and mainline station either on your door step or close by



### Nearest Schools

Primary Schools: Davington Primary 0.4 miles, Ethelbert Road Infant School 0.5 miles

Secondary Schools: Queen Elizabeth's Grammar School 0.2 miles, The Abbey School 0.6 miles



### Transport Information

Train Stations: Faversham 0.3 miles, Selling 3.4 miles, Teynham 3.8 miles



### Address

Court Street, Faversham, Kent, ME13



### Directions

For directions to this property please contact us.





**Wards**  
Helping you move forwards

Call Faversham Branch 01795 535517 ■ [wardsofkent.co.uk](http://wardsofkent.co.uk)



- Legal advice should be taken to verify fixtures/fittings, planning, alterations and/or lease details
- Appliances & services are untested, dimensions are approximate and floor plans are not to scale
- Through a Homewise Home For Life Plan people aged 60+ can secure this property for up to 59% less, by purchasing a Lifetime Lease.



10831670/20230502/HR/PJ