



**Price**  
**£380,000**

**Freehold**

3x  1x  1x 

**The Maple, Faversham  
Lakes, Ham Road,  
Faversham, Kent, ME13**

*Wards*  
Helping you move forwards





## Main features

- A beautiful family home part of the Faversham Lakes development
- Spacious open plan living
- Bespoke, high-specification kitchen
- Allocated off-road parking for 2 cars
- Award winning developer



## Accommodation

### GROUND FLOOR

Entrance Hall

Cloakroom

Kitchen: 11'11 x 8'1 (3.63m x 2.47m)

Living/Dining Area: 17'9 x 15'7 (5.41m x 4.75m)

### FIRST FLOOR

Landing

Bedroom 1: 13'9 x 8'10 (4.19m x 2.69m)

En-Suite Shower Room

Bedroom 2: 10'8 x 8'1 (3.25m x 2.47m)

Bedroom 3: 10'3 x 6'5 (3.13m x 1.96m)

Bathroom: 7'2 x 6'7 (2.19m x 2.01m)

### OUTSIDE

Rear Garden

Parking for 2 cars

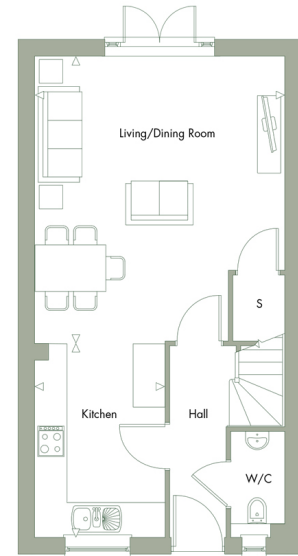

The Maple - Ground Floor

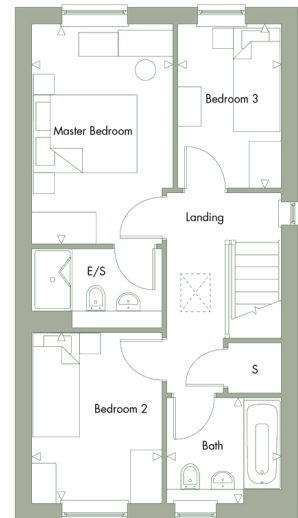

The Maple - First Floor



**Call Faversham - 01795 535517 ■ [wardsofkent.co.uk](http://wardsofkent.co.uk)**

- If buying to let, the energy rating will need to be improved to at least 'E' rating before you can let the property
- Legal advice should be taken to verify fixtures/fittings, planning, alterations and/or lease details
- Appliances & services are untested, dimensions are approximate and floor plans are not to scale



10831748/20230317/JB/PJ