



**OVER 60?**

Secure this property  
for up to **59% less!**

**Price**

**£235,000**

**Freehold**

2x  1x  1x 

**Water Lane, Ospringe,  
Faversham, Kent, ME13**

*Wards*  
Helping you move forwards



## Main features

- Period terraced cottage
- Walking distance to town centre
- Well presented modern style interior
- Easy to manage courtyard style garden
- No onward chain

## Ground Floor

Approx. 28.1 sq. metres (302.7 sq. feet)



## First Floor

Approx. 22.7 sq. metres (244.7 sq. feet)

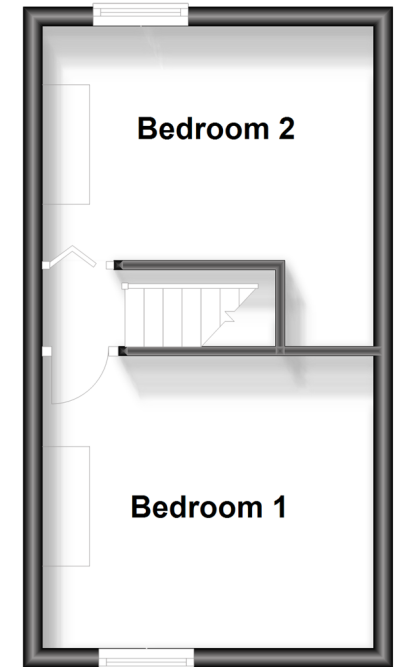

## Accommodation

### GROUND FLOOR

Lounge: 11'2 x 10'2 (3.41m x 3.10m)

Kitchen/Diner: 11'2 x 10'9 (3.41m x 3.28m)

Bathroom

### FIRST FLOOR

Landing

Bedroom 1: 11'1 x 10'3 (3.38m x 3.13m)

Bedroom 2: 11'2 x 8'0 (3.41m x 2.44m)

### OUTSIDE

Court Yard Garden

**Call Faversham - 01795 535517 ■ [wardsof Kent.co.uk](http://wardsof Kent.co.uk)**

- Legal advice should be taken to verify fixtures/fittings, planning, alterations and/or lease details
- Appliances & services are untested, dimensions are approximate and floor plans are not to scale
- Through a Homewise Home For Life Plan people aged 60+ can secure this property for up to 59% less, by purchasing a Lifetime Lease.



10831867/20240102/PJ/PJ