



OVER 60?

Secure this property
for up to **59% less!**

Price

£525,000

Freehold

3x  1x  2x 

**Briton Road, Faversham,
Kent, ME13**

Wards
Helping you move forwards

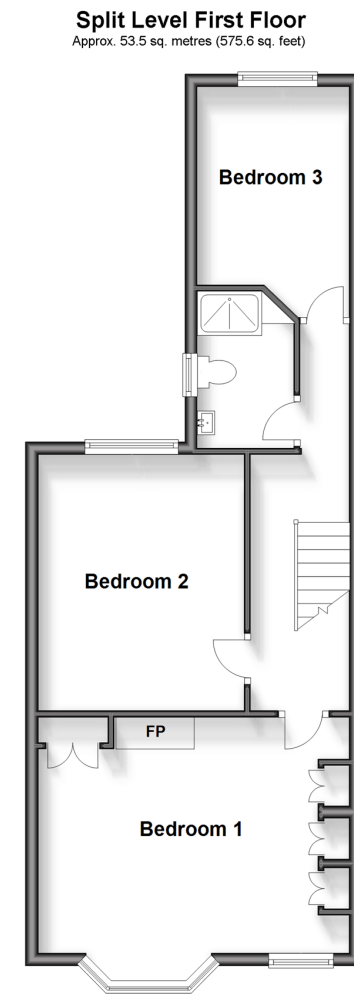
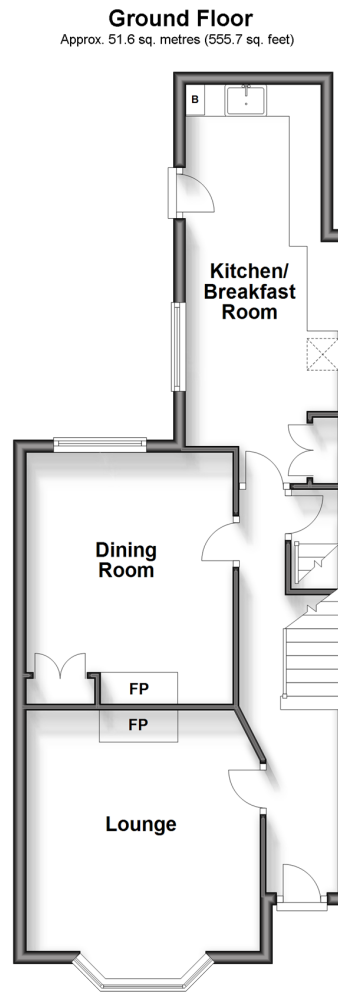
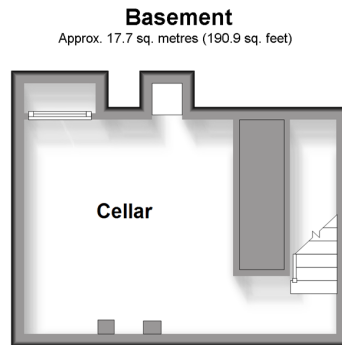

Accommodation

GROUND FLOOR

Entrance Hall
Lounge: 14'6 x 12'5 (4.42m x 3.79m)
Dining Room: 13'2 x 11'1 (4.02m x 3.38m)
Kitchen/Breakfast Area: 18'9 x 7'11 (5.72m x 2.41m)

BASEMENT

Cellar: 12'9 x 10'9 (3.89m x 3.28m)

FIRST FLOOR

Landing
Bedroom 1: 16'7 x 14'11 (5.06m x 4.55m)
Bedroom 2: 13'3 x 11'2 (4.04m x 3.41m)
Bedroom 3: 10'1 x 7'11 (3.08m x 2.41m)
Shower Room

OUTSIDE

Front Garden
Rear Garden
Outside Toilet



Main features

- Well presented Victorian house in prominent town centre location
- Light and spacious interior with many period features
- Short stroll to mainline station
- Manageable sized garden with rear access
- Planning consent granted for rear single storey extension



Nearest Schools

Primary Schools: Ethelbert Road Infant School 0.4 miles, St Mary of Charity CE (Aided) Primary 0.7 miles

Secondary Schools: The Abbey School 0.5 miles, Queen Elizabeth's Grammar School 0.8 miles



Transport Information

Train Stations: Faversham 0.1 miles, Selling 3.3 miles, Teynham 3.7 miles



Address

Briton Road, Faversham, Kent, ME13



Directions

For directions to this property please contact us.



Call Faversham Branch 01795 535517 ■ wardsofkent.co.uk



- Legal advice should be taken to verify fixtures/fittings, planning, alterations and/or lease details
- Appliances & services are untested, dimensions are approximate and floor plans are not to scale
- Through a Homewise Home For Life Plan people aged 60+ can secure this property for up to 59% less, by purchasing a Lifetime Lease.



10832007/20240515/HR/PJ