



**OVER 60?**

Secure this property  
for up to **59% less!**

**Price**  
**£240,000**

**Freehold**

2x  1x  1x 

**Hamilton Road,  
Gillingham, Kent, ME7**

*Wards*  
Helping you move forwards





## Main features

- Rarely available semi-detached bungalow at an affordable price
- Modern kitchen and bathroom
- Low maintenance rear garden
- Gas central heating & double glazing
- Ideal for anyone looking for accommodation all on one level

## Accommodation

### GROUND FLOOR

Lounge: 12'0 x 9'4 (3.66m x 2.85m)

Kitchen: 11'7 x 7'4 (3.53m x 2.24m)

Lobby/Utility Area

Shower Room

Inner Hall

Bedroom 1: 11'7 into bay x 10'2 (3.53m x 3.10m)

Bedroom 2 : 8'4 x 7'5 (2.54m x 2.26m)

### OUTSIDE

Front Garden

Rear Garden

**Ground Floor**  
Approx. 47.2 sq. metres (508.4 sq. feet)

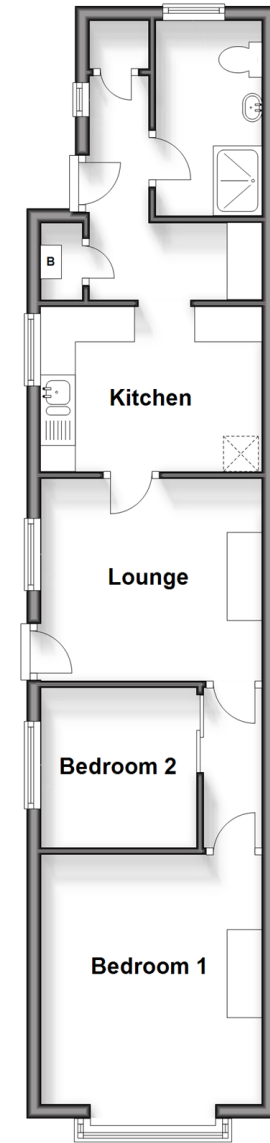

**Call Gillingham - 01634 851191 ■ [wardsofkent.co.uk](http://wardsofkent.co.uk)**

- Legal advice should be taken to verify fixtures/fittings, planning, alterations and/or lease details
- Appliances & services are untested, dimensions are approximate and floor plans are not to scale
- Through a Homewise Home For Life Plan people aged 60+ can secure this property for up to 59% less, by purchasing a Lifetime Lease.



10923197/20240311/JS/GS