



**Price**  
**£370,000**

**Freehold**

3x  2x  1x 

**Wilberforce Way,  
Gravesend, Kent, DA12  
5DG**



**Video Tour available**

**Wards**  
Helping you move forwards



## Main features

- New-build family home set over 3 floors with off road parking
- En-suite shower room and family bathroom
- Downstairs cloakroom
- Walking distance to shops and schools
- Short drive to A2/M2 motorway networks

## Accommodation

### GROUND FLOOR

Entrance Hall

Lounge/Diner: 23'0 x 10'9 (7.02m x 3.28m)

Kitchen : 11'3 x 9'3 (3.43m x 2.82m)

Cloakroom

### FIRST FLOOR

Landing

Bedroom 1: 15'3 x 12'7 (4.65m x 3.84m)

En-Suite Shower Room

Bedroom 2: 15'4 x 12'4 (4.68m x 3.76m)

Bathroom

### SECOND FLOOR

Landing

Bedroom 3: 18'4 x 11'6 (5.59m x 3.51m)

### OUTSIDE

Front and Rear Gardens

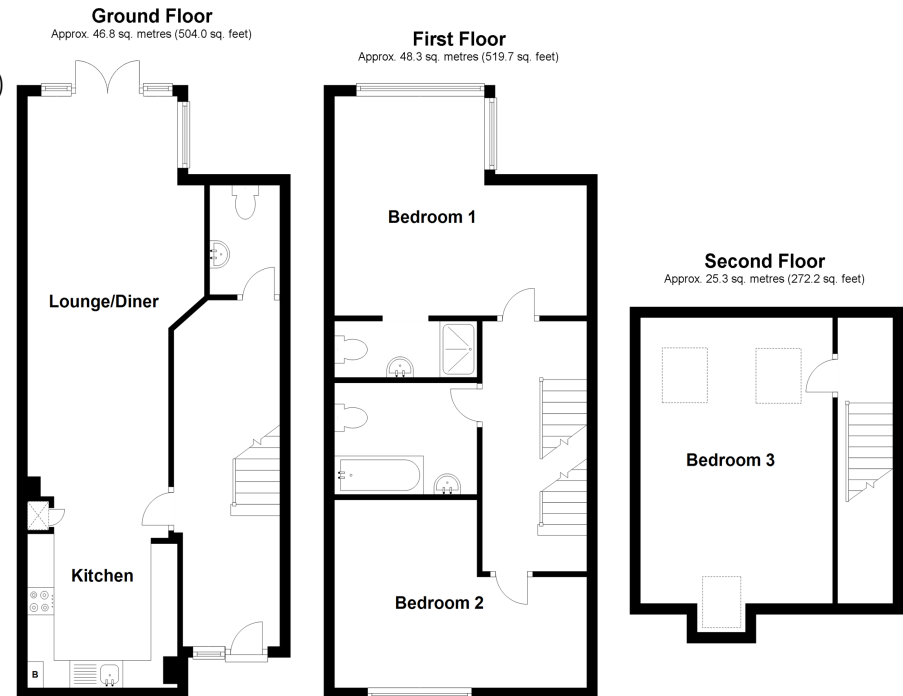

**Call Gravesend - 01474 352417 ■ [wardsof Kent.co.uk](http://wardsof Kent.co.uk)**

- Legal advice should be taken to verify fixtures/fittings, planning, alterations and/or lease details
- Appliances & services are untested, dimensions are approximate and floor plans are not to scale

