



**Price**  
**£175,000**

**Leasehold**

1x  1x  1x 

**St. Marys Court, Station  
Road, Pier Heights,  
Herne Bay, Kent, CT6**

**OVER 60?**

Secure this property  
for up to **59% less!**

*Wards*  
Helping you move forwards





## Main features

- Beautifully presented prestigious building
- Centrally located, close to the station
- Third floor, lift servicing all floors
- Allocated parking and small balcony with wonderful views
- Modern styling with newly fitted kitchen

## Accommodation

### THIRD FLOOR

Entrance Hall

Kitchen : 10'7 x 8'4 (3.23m x 2.54m)

Lounge: 16'2 x 11'9 (4.93m x 3.58m)

Bedroom: 11'7 x 10'4 (3.53m x 3.15m)

Bathroom

### OUTSIDE

Communal Gardens

Allocated Parking

Visitor Parking

## Third Floor

Approx. 47.5 sq. metres (511.1 sq. feet)

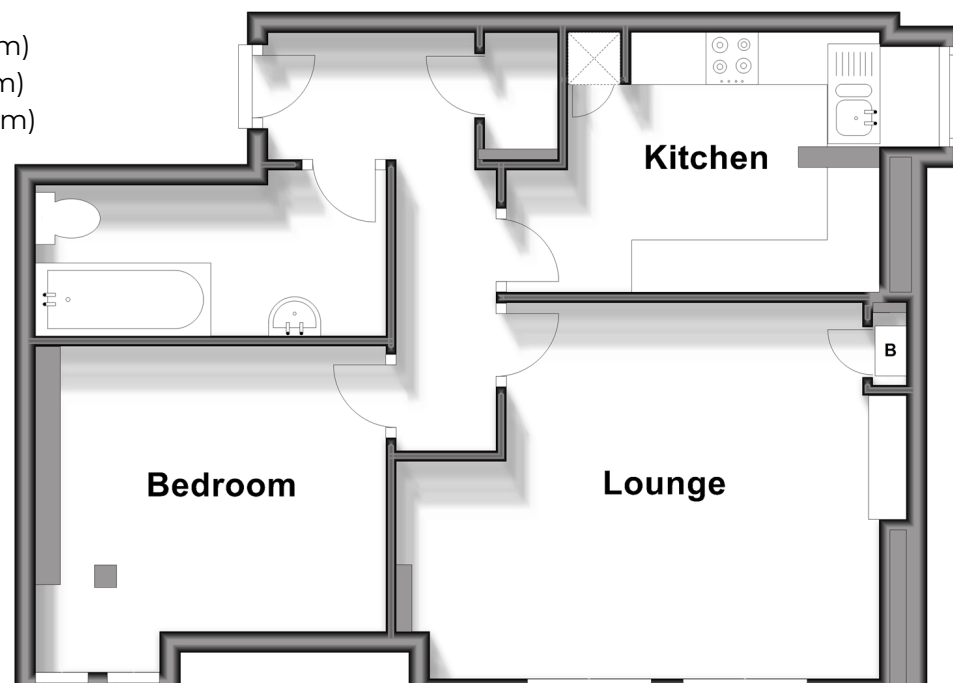

**Call Herne Bay - 01227 361226 ■ [wardsofkent.co.uk](http://wardsofkent.co.uk)**

- Legal advice should be taken to verify fixtures/fittings, planning, alterations and/or lease details
- Appliances & services are untested, dimensions are approximate and floor plans are not to scale
- Through a Homewise Home For Life Plan people aged 60+ can secure this property for up to 59% less, by purchasing a Lifetime Lease.



11237441/20240105/GS/GG