



Price
£320,000

Freehold

2x  1x  1x 

**Woodland Road,
Herne Bay,
Kent, CT6**

OVER 60?

Secure this property
for up to **59% less!**

Wards
Helping you move forwards

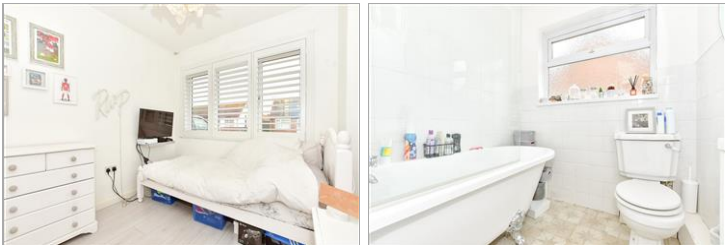

Main features

- Fully refurbished with quality fittings
- Rewired and new boiler
- Modern styling, plantation shutters
- Block-paved driveway leading to garage
- Close to Herne Bay High School and bus service

Accommodation

GROUND FLOOR

Entrance Hall

Bedroom 1: 12'4 x 11'3 (3.76m x 3.43m)

Lounge: 13'2 x 11'2 (4.02m x 3.41m)

Kitchen: 11'8 x 8'1 (3.56m x 2.47m)

Bathroom

Bedroom 2: 8'10 x 8'0 (2.69m x 2.44m)

OUTBUILDING

Garage

OUTSIDE

Driveway

Front Garden

Rear Garden

Ground Floor

Approx. 54.5 sq. metres (586.5 sq. feet)

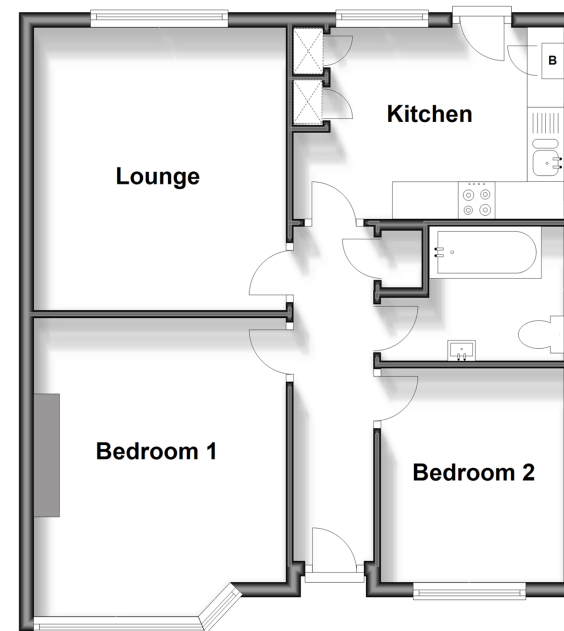

Outbuilding

Approx. 16.5 sq. metres (177.4 sq. feet)

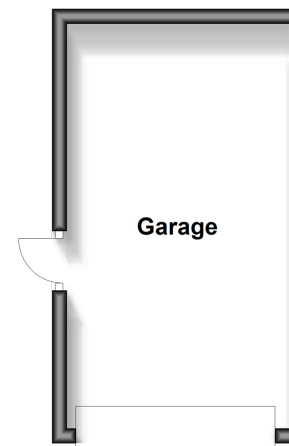

Call Herne Bay - 01227 361226 ■ wardsofkent.co.uk

- Legal advice should be taken to verify fixtures/fittings, planning, alterations and/or lease details
- Appliances & services are untested, dimensions are approximate and floor plans are not to scale
- Through a Homewise Home For Life Plan people aged 60+ can secure this property for up to 59% less, by purchasing a Lifetime Lease.

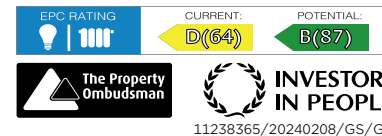

11238365/20240208/GS/GG