



OVER 60?

Secure this property
for up to **59% less!**

Price

£165,000

Leasehold

1x  1x  1x 

**Cherry Hill Court,
Callaways Lane,
Newington, Kent, ME9**

Wards
Helping you move forwards



Main features

- A smartly presented ground floor maisonette offering excellent value for money
- Open plan kitchen/living area
- Low maintenance rear garden
- Allocated parking
- Popular village location
- No forward chain

Accommodation

GROUND FLOOR

Porch
 Kitchen/Living Area : 15'7 x 12'6 (4.75m x 3.81m)
 Bedroom 1 : 11'0 x 9'5 (3.36m x 2.87m)
 Bathroom

OUTSIDE

Front Garden
 Rear Garden
 Allocated Parking

Ground Floor

Approx. 34.8 sq. metres (374.2 sq. feet)

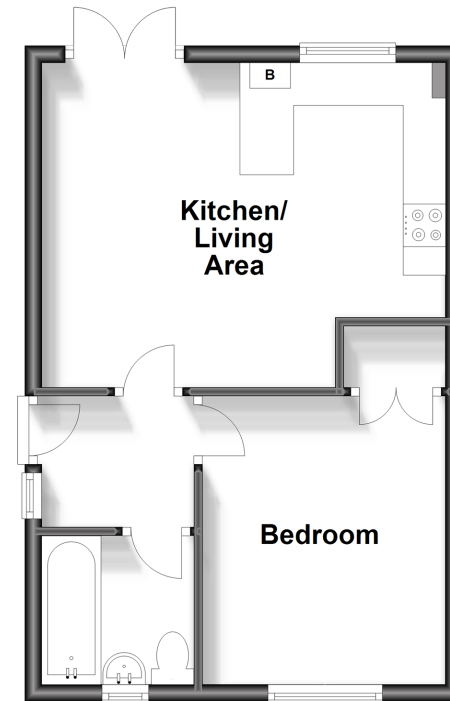

Call Rainham - 01634 373531 ■ wardsofkent.co.uk

- The seller is a person connected with Wards as defined in the Estate Agents Act 1979
- Appliances & services are untested, dimensions are approximate and floor plans are not to scale

- Legal advice should be taken to verify fixtures/fittings, planning, alterations and/or lease details
- Through a Homewise Home For Life Plan people aged 60+ can secure this property for up to 59% less, by purchasing a Lifetime Lease.