



Price
£240,000

Freehold

2x  1x  2x 

**Richard Street,
Rochester, Kent, ME1**

OVER 60?

Secure this property
for up to **59% less!**

Wards
Helping you move forwards



Main features

- Perfect first time buy or investment opportunity
- Secluded rear garden
- Upstairs bathroom
- Close to historic High Street with high speed train station
- Offered with no forward chain

Accommodation

SPLIT LEVEL GROUND FLOOR

Lounge: 11'10 x 10'10 (3.61m x 3.30m)
Dining Room: 12'0 x 10'8 (3.66m x 3.25m)
Kitchen: 8'9 x 6'1 (2.67m x 1.86m)

SPLIT LEVEL FIRST FLOOR

Landing
Bedroom 1: 11'7 x 10'10 (3.53m x 3.30m)
Bedroom 2: 12'1 x 10'9 (3.69m x 3.28m)
Bathroom: 8'8 x 5'11 (2.64m x 1.80m)

OUTSIDE

Rear Garden

Split Level Ground Floor

Approx. 32.9 sq. metres (354.1 sq. feet)

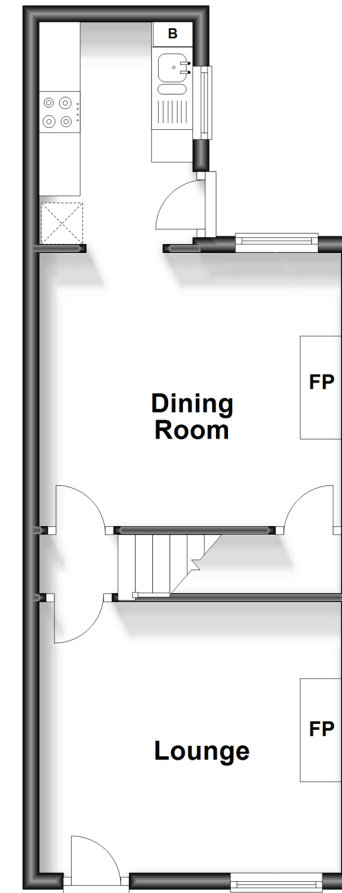

Split Level First Floor

Approx. 32.9 sq. metres (354.1 sq. feet)



Call Rochester - 01634 830925 ■ wardsofkent.co.uk

- Legal advice should be taken to verify fixtures/fittings, planning, alterations and/or lease details
- Appliances & services are untested, dimensions are approximate and floor plans are not to scale
- Through a Homewise Home For Life Plan people aged 60+ can secure this property for up to 59% less, by purchasing a Lifetime Lease.



11529183/20231012/DM/AB