



Price
£180,000

Freehold

3x  1x  1x 

**Cliff View Gardens,
Minster On Sea, Kent,
ME12**

OVER 60?

Secure this property
for up to **59% less!**

Wards
Helping you move forwards



Main features

- No onward chain
- Literally just around the corner from the beach
- A brisk walk into Leysdown Promenade with its arcades
- Great size kitchen/diner with double doors out to the garden
- Nice size lounge to relax in

Accommodation

GROUND FLOOR

Lounge: 16'0 x 11'1 (4.88m x 3.38m)
Kitchen/Diner: 15'1 x 12'0 (4.60m x 3.66m)

FIRST FLOOR

Landing
Bedroom 1: 11'1 x 8'10 (3.38m x 2.69m)
Bedroom 2: 9'0 x 8'0 (2.75m x 2.44m)
Bedroom 3: 8'10 x 6'1 (2.69m x 1.86m)
Bathroom: 7'0 x 6'1 (2.14m x 1.86m)

OUTSIDE

Front Garden
Rear Garden

Ground Floor

Approx. 34.2 sq. metres (368.6 sq. feet)

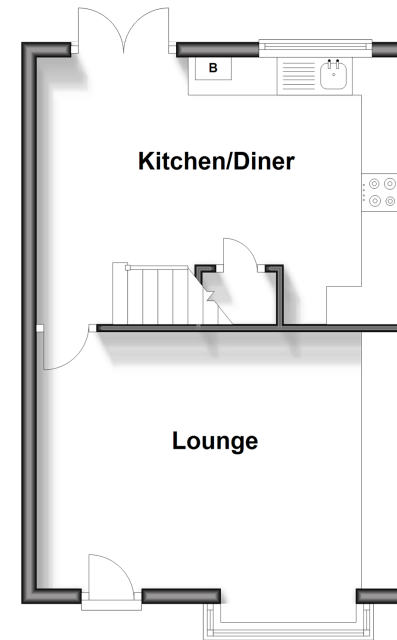

First Floor

Approx. 33.8 sq. metres (364.3 sq. feet)

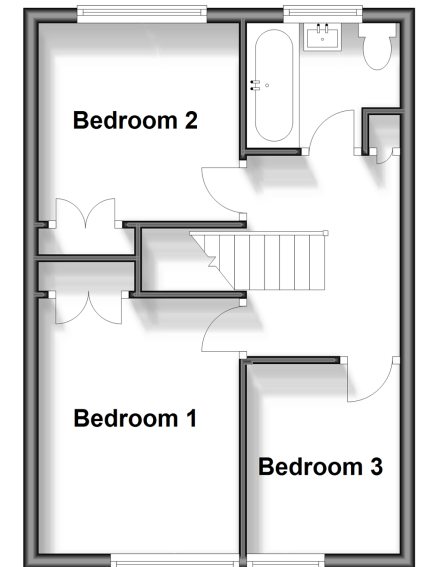

Call Sheerness - 01795 664651 ■ wardsofkent.co.uk

■ Legal advice should be taken to verify fixtures/fittings, planning, alterations and/or lease details
■ Through a Homewise Home For Life Plan people aged 60+ can secure this property for up to 59% less, by purchasing a Lifetime Lease.

■ Appliances & services are untested, dimensions are approximate and floor plans are not to scale