



Price

£320,000

Freehold

3x  2x  1x 

**Belgrave Place,
Belgrave Avenue,
Minster-On-Sea, Kent,
ME12**

Wards
Helping you move forwards



Main features

- Brand new detached home
- 837 sq. ft. of living space
- En-Suite to the main bedroom plus a family bathroom
- Newly fitted kitchen with built in appliances
- French doors in living area to the rear garden

Accommodation

GROUND FLOOR

Entrance Hall
Downstairs Cloakroom
Kitchen/Dining Area: 15'2 x 8'9 (4.63m x 2.67m)
Lounge: 15'7 x 11'6 (4.75m x 3.51m)

FIRST FLOOR

Landing
Bedroom 1: 10'10 x 8'7 (3.30m x 2.62m)
En-suite Shower Room
Bedroom 2: 10'2 x 8'7 (3.10m x 2.62m)
Bedroom 3: 10'5 x 6'9 (3.18m x 2.06m)
Bathroom

OUTSIDE

Front Garden
Front Driveway
Rear Garden

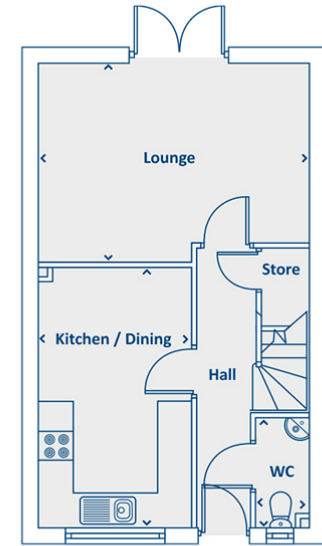

Ground Floor

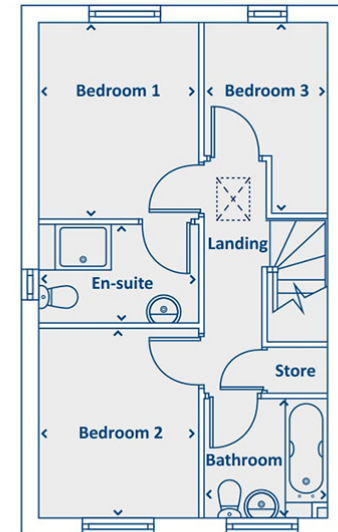

First Floor

Call Sheerness - 01795 664651 ■ wardsofkent.co.uk

- If buying to let, the energy rating will need to be improved to at least 'E' rating before you can let the property
- Legal advice should be taken to verify fixtures/fittings, planning, alterations and/or lease details
- Appliances & services are untested, dimensions are approximate and floor plans are not to scale



11635216/20240408/DS/JLS