



OVER 60?

Secure this property
for up to **59% less!**

Price

£160,000

Leasehold

1x  1x  1x 

**Wickham Close,
Newington,
Sittingbourne, Kent,
ME9**

Wards
Helping you move forwards



Main features

- Perfect property for first time buyers, downsizing or investors
- Well presented throughout and ready to move into
- Benefits from an allocated parking space and garage
- Situated in a popular village location
- Close to the train station and amenities

Accommodation

GROUND FLOOR

Porch

Lounge: 13'7 x 11'2 (4.14m x 3.41m)

Kitchen: 9'11 x 4'11 (3.02m x 1.50m)

Bedroom : 11'10 x 9'10 (3.61m x 3.00m)

Bathroom

OUTBUILDING

Garage

OUTSIDE

Front Garden

Allocated Parking

Ground Floor

Approx. 43.4 sq. metres (466.9 sq. feet)

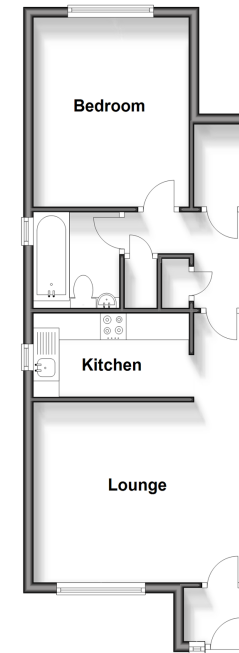

Outbuilding

Approx. 0.0 sq. metres (0.0 sq. feet)

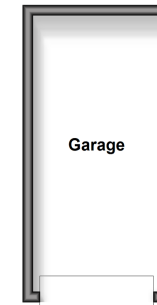

Call Rainham - 01634 373531 ■ wardsofkent.co.uk

■ Legal advice should be taken to verify fixtures/fittings, planning, alterations and/or lease details
 ■ Through a Homewise Home For Life Plan people aged 60+ can secure this property for up to 59% less, by purchasing a Lifetime Lease.

■ Appliances & services are untested, dimensions are approximate and floor plans are not to scale