



**Price**  
**£400,000**

**Freehold**

3x  1x  1x 

**Cherry Fields, Lynsted  
Lane, Sittingbourne,  
Kent, ME9**

*Wards*  
Helping you move forwards





## Main features

- Off road parking plus carport
- Fantastic condition throughout and ready to move into
- Situated in a semi-rural location but also close to shops and fields if you like a Sunday afternoon stroll
- Shared ownership of 50%
- Spacious semi-detached house

## Accommodation

### GROUND FLOOR

Entrance Hall

Lounge: 17'1 x 10'4 (5.21m x 3.15m)

Kitchen/Diner: 17'3 x 10'5 (5.26m x 3.18m)

Cloakroom

### FIRST FLOOR

Landing

Bedroom 1: 13'4 x 9'2 (4.07m x 2.80m)

Bedroom 2: 14'2 x 10'1 (4.32m x 3.08m)

Bedroom 3: 9'10 x 7'7 (3.00m x 2.31m)

Shower Room

### OUTSIDE

Front Garden

Off Road Parking

Carport

Rear Garden

### Ground Floor

Approx. 44.5 sq. metres (478.8 sq. feet)

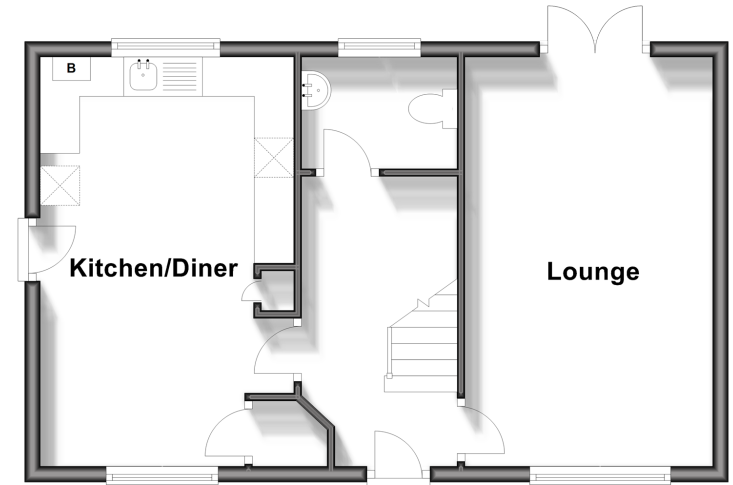

### First Floor

Approx. 44.5 sq. metres (478.8 sq. feet)

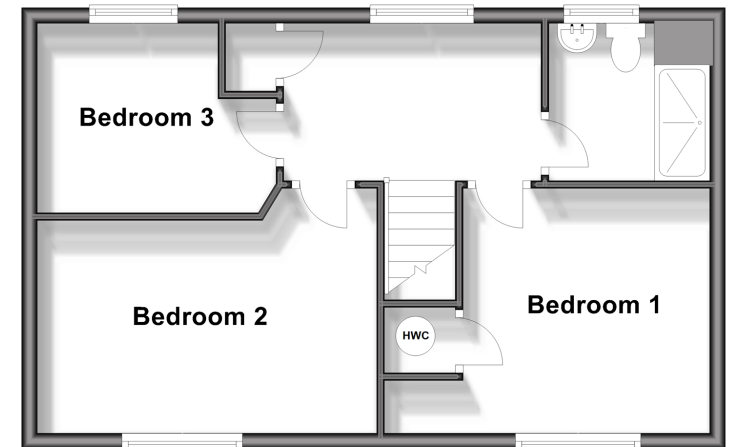

**Call Sittingbourne - 01795 427272 ■ [wardsof Kent.co.uk](http://wardsof Kent.co.uk)**

- Legal advice should be taken to verify fixtures/fittings, planning, alterations and/or lease details
- Appliances & services are untested, dimensions are approximate and floor plans are not to scale



11738162/20231113/KC/JS