



Price
£160,000

Leasehold

1x  1x  1x 

**Brenchley House, High
Street, Milton Regis,
Sittingbourne, Kent,
ME10**

Wards
Helping you move forwards



Main features

- Immaculately presented with modern decor throughout
- End of chain
- Allocated parking
- Set in Sittingbourne High Street close to local shops and amenities
- Perfect for first time buyers and investors alike

Accommodation

FIRST FLOOR

Lounge: 17'4 x 12'7 (5.29m x 3.84m)

Bedroom: 11'3 x 9'9 (3.43m x 2.97m)

Bathroom: 9'8 x 5'6 (2.95m x 1.68m)

OUTSIDE

Allocated Parking

First Floor

Approx. 39.7 sq. metres (427.7 sq. feet)

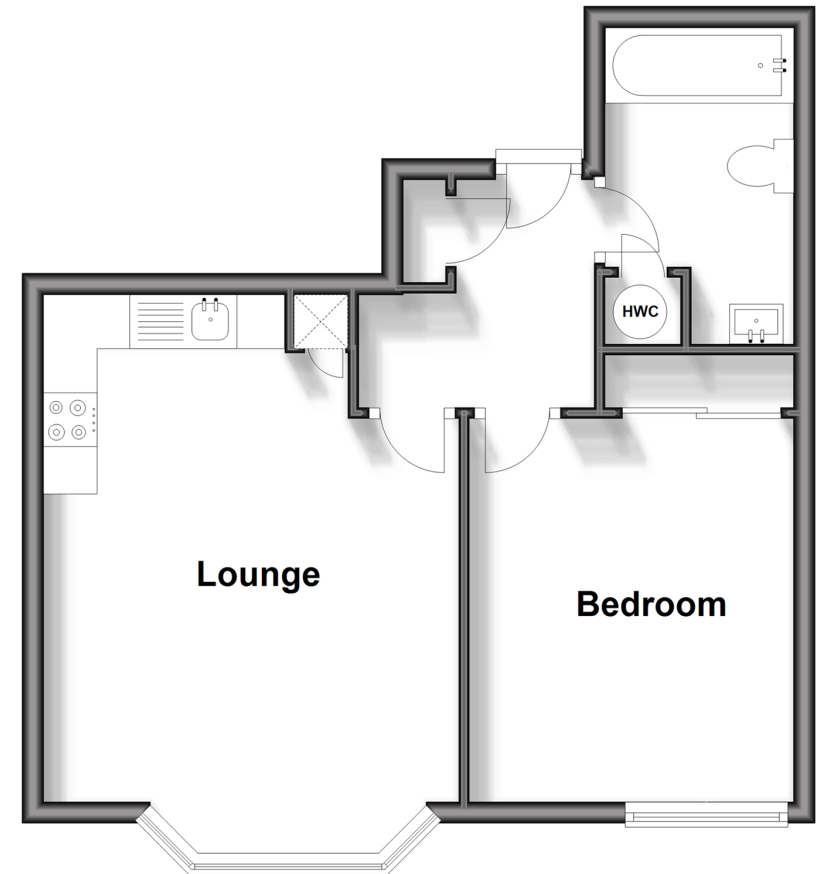

Call Sittingbourne - 01795 427272 ■ wardsof Kent.co.uk

- Legal advice should be taken to verify fixtures/fittings, planning, alterations and/or lease details
- Appliances & services are untested, dimensions are approximate and floor plans are not to scale



11738256/20240418/KC/TB