



Guide Price
£500,000

Freehold

3x  2x  3x 

**Cherry Orchard,
Chestfield, Whitstable,
Kent, CT5**

OVER 60?

Secure this property
for up to **59% less!**

Wards
Helping you move forwards



Main features

- Detached chalet bungalow
- Very sought after, quiet location
- Close proximity to golf course
- Great sized rooms throughout
- Very flexible accommodation

Accommodation

GROUND FLOOR

Entrance Porch

Hallway

Lounge: 19'0 x 12'8 into fitted wardrobes
(5.80m x 3.86m)

Kitchen: 9'9 x 9'6 (2.97m x 2.90m)

Dining Room: 12'6 x 8'6 (3.81m x 2.59m)

Shower Room: 6'2 x 4'7 (1.88m x 1.40m)

Study: 16'1 x 7'7 (4.91m x 2.31m)

Bedroom 1: 12'9 x 11'1 (3.89m x 3.38m)

Bedroom 2: 10'9 x 10'6 (3.28m x 3.20m)

Bathroom: 7'4 x 6'3 (2.24m x 1.91m)

Conservatory: 11'5 x 8'0 (3.48m x 2.44m)

FIRST FLOOR

Loft Room: 12'8 x 11'3 (3.86m x 3.43m)

OUTSIDE

Off Street Parking

Front Garden

Rear Garden

Call Whitstable - 01227 772272 ■ wardsofkent.co.uk

- Legal advice should be taken to verify fixtures/fittings, planning, alterations and/or lease details
- Appliances & services are untested, dimensions are approximate and floor plans are not to scale
- Through a Homewise Home For Life Plan people aged 60+ can secure this property for up to 59% less, by purchasing a Lifetime Lease.

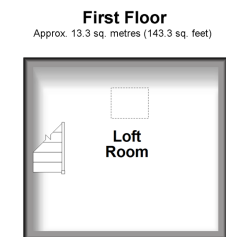
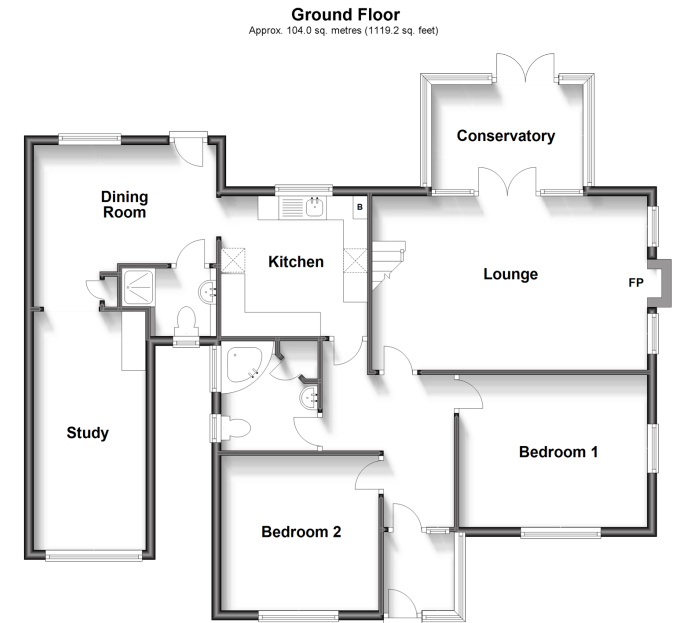

12033182/20231114/AR/MR