



Price
£355,000

Freehold

2x  2x  1x 

**Nassella Gardens,
Chestfield, Whitstable,
Kent, CT5**

Wards
Helping you move forwards



Main features

- **Bespoke design fully fitted kitchen with Bosch integrated appliances**
- **Fitted wardrobes to main bedroom**
- **Contemporary bathroom suites with heated towel rails**
- **Smart heating controls to monitor your energy usage**
- **10-year NHBC warranty for peace of mind**

Accommodation

GROUND FLOOR

Entrance Hallway
Cloakroom
Kitchen: 12'7 x 7'3 (3.84m x 2.21m)
Lounge/Dining: 16'3 x 14'3 (4.96m x 4.35m)

FIRST FLOOR

Bedroom 1: 11'8 x 10'6 (3.56m x 3.20m)
En Suite Shower Room
Bedroom 2: 14'6 x 9'6 (4.42m x 2.90m)
Bathroom
Landing

OUTSIDE

Front Garden
Parking
Rear Garden

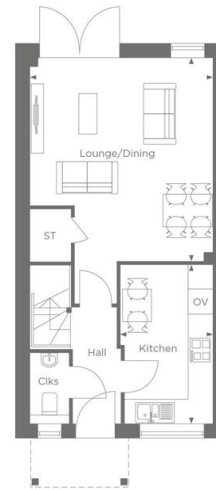

Ground Floor

Kitchen	3.90m x 2.25m	12'7" x 7'3"
Lounge/Dining	4.97m x 4.46m	16'3" x 14'3"



First Floor

Bedroom 1	3.62m x 3.26m	11'8" x 10'6"
Bedroom 2	4.46m x 2.95m	14'6" x 9'6"

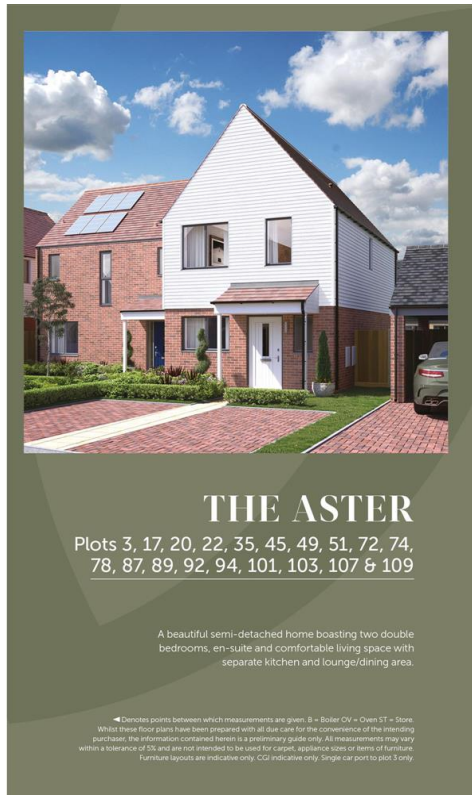

THE ASTER

Plots 3, 17, 20, 22, 35, 45, 49, 51, 72, 74, 78, 87, 89, 92, 94, 101, 103, 107 & 109

A beautiful semi-detached home boasting two double bedrooms, en-suite and comfortable living space with separate kitchen and lounge/dining area.

■ Denotes points between which measurements are given. B = Boiler OV = Oven ST = Store.
While these floor plans have been prepared with all due care for the convenience of the intending purchaser, the information contained herein is a preliminary guide only. All measurements may vary within a tolerance of 5% and are not intended to be used for carpet, appliance sizes or items of furniture. Furniture layouts are indicative only. COT indicates only. Single car ports to plot 3 only.

Call Whitstable - 01227 772272 ■ wardsofKent.co.uk

- If buying to let, the energy rating will need to be improved to at least 'E' rating before you can let the property
- Appliances & services are untested, dimensions are approximate and floor plans are not to scale

■ Legal advice should be taken to verify fixtures/fittings, planning, alterations and/or lease details



12033201/20231031/JB/MR