



Price
£435,000

Freehold

3x  2x  1x 

**Plot 91, Nassella
Gardens, Grasmere
Gardens (Phase 1),
Chestfield, Whitstable,**

OVER 60?

Secure this property
for up to **59% less!**

Wards
Helping you move forwards



Main features

- Bespoke design fully fitted kitchen with Bosch integrated appliances
- Fitted wardrobes to main bedroom
- Contemporary bathroom suites with heated towel rails
- Smart heating controls to monitor your energy usage
- 10-year NHBC warranty for peace of mind

Accommodation

GROUND FLOOR

Kitchen: 13'1 x 8'8 (3.99m x 2.64m)

Lounge/Dining: 18'7 x 13'6 (5.67m x 4.12m)

FIRST FLOOR

Bedroom 1: 12'1 x 11'0 (3.69m x 3.36m)

Bedroom 2: 10'1 x 9'5 (3.08m x 2.87m)

Bedroom 3: 10'5 x 8'3 (3.18m x 2.52m)

Bathroom

En Suite Shower Room

OUTSIDE

Rear Garden

Car Port

Allocated Parking Space

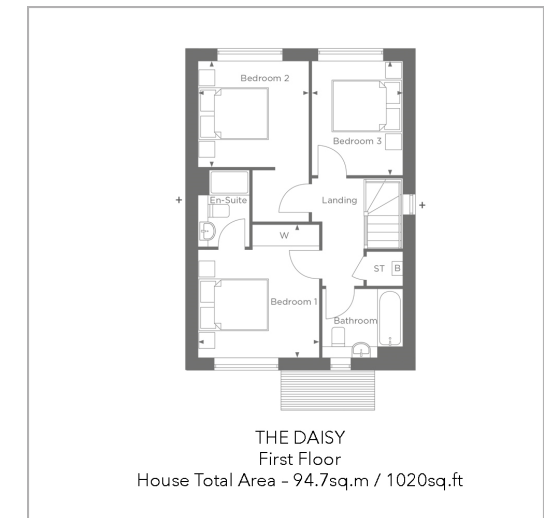
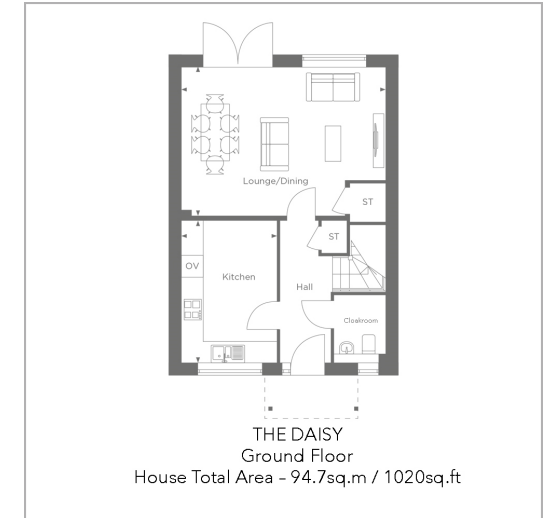

Call Whitstable - 01227 772272 ■ wardsofkent.co.uk

- If buying to let, the energy rating will need to be improved to at least 'E' rating before you can let the property
- Legal advice should be taken to verify fixtures/fittings, planning, alterations and/or lease details
- Appliances & services are untested, dimensions are approximate and floor plans are not to scale
- Through a Homewise Home For Life Plan people aged 60+ can secure this property for up to 59% less, by purchasing a Lifetime Lease.



12033228/20230623/JP/MR