



OVER 60?

Secure this property
for up to **59% less!**

Price

£220,000

Leasehold

2x  1x  1x 

**St. John's Road,
Whitstable, Kent, CT5**

Wards
Helping you move forwards



Main features

- Purpose built maisonette with a shared driveway and rear garden
- Chain-free
- Spacious feel to all rooms
- 950 year lease, no service charge, ground rent £40per month
- Newly laid carpets

Accommodation

GROUND FLOOR

Hallway

Bedroom 2 : 8'7 x 8'2 (2.62m x 2.49m)

Bedroom 1 : 13'9 x 10'5 (4.19m x 3.18m)

Wet Room

Kitchen : 8'9 x 8'2 (2.67m x 2.49m)

Lounge: 13'9 x 10'6 (4.19m x 3.20m)

OUTSIDE

Shared garden

Shared driveway parking

Ground Floor

Approx. 58.6 sq. metres (630.7 sq. feet)

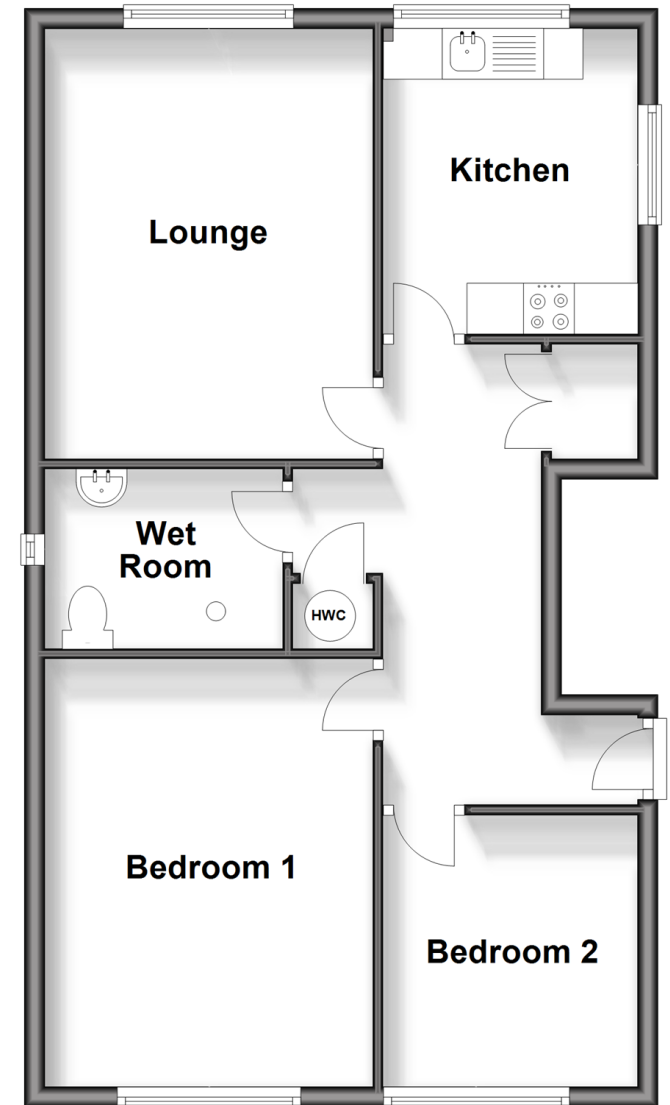

Call Whitstable - 01227 772272 ■ wardsofkent.co.uk

- Legal advice should be taken to verify fixtures/fittings, planning, alterations and/or lease details
- Appliances & services are untested, dimensions are approximate and floor plans are not to scale
- Through a Homewise Home For Life Plan people aged 60+ can secure this property for up to 59% less, by purchasing a Lifetime Lease.

EPC RATING	CURRENT:	POTENTIAL:
	D(57)	C(71)
12033353/20240309/AR/NF		