



OVER 60?

Secure this property
for up to **59% less!**

Price

£290,000

Freehold

2x  1x  1x 

**Sherwood Drive,
Whitstable, Kent, CT5**

Wards
Helping you move forwards



Main features

- Annually serviced combi-boiler
- Neutrally presented throughout
- An excellent community feeling, opposite a communal green area
- Both bedrooms benefit from built-in wardrobe space
- Potential to add off-road parking with rear access to the garden

Accommodation

GROUND FLOOR

Porch

Lounge: 13'0 x 11'5 (3.97m x 3.48m)

Kitchen/Diner: 14'5 x 9'0 (4.40m x 2.75m)

Conservatory : 12'11 x 7'10 (3.94m x 2.39m)

FIRST FLOOR

Landing

Bathroom

Bedroom 2: 10'1 x 8'1 (3.08m x 2.47m)

Bedroom 1 : 14'6 into bay x 10'1 (4.42m x 3.08m)

OUTSIDE

Front Garden

Rear Garden

Ground Floor

Approx. 40.5 sq. metres (435.7 sq. feet)

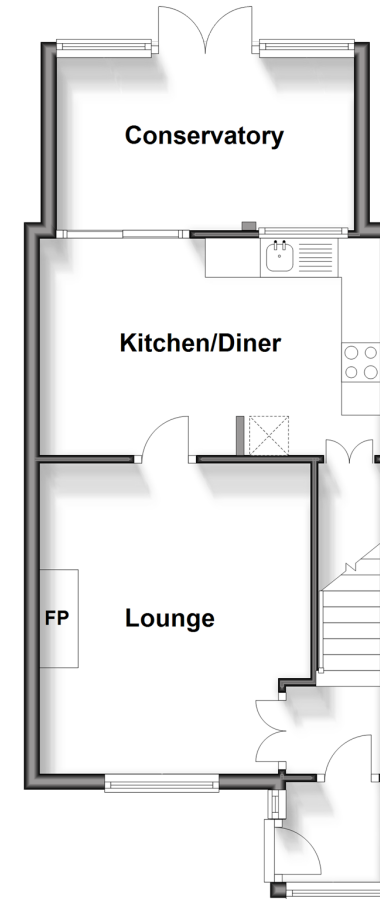

First Floor

Approx. 29.8 sq. metres (320.4 sq. feet)

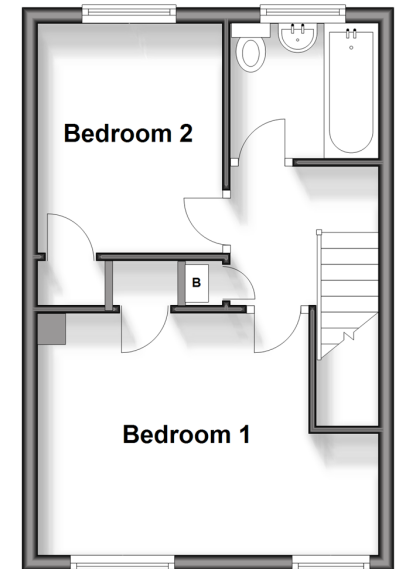

Call Whitstable - 01227 772272 ■ wardsofkent.co.uk

- Legal advice should be taken to verify fixtures/fittings, planning, alterations and/or lease details
- Appliances & services are untested, dimensions are approximate and floor plans are not to scale
- Through a Homewise Home For Life Plan people aged 60+ can secure this property for up to 59% less, by purchasing a Lifetime Lease.



12033373/20240205/AR/NF