



**Price**  
**£400,000**

**Freehold**

3x  2x  1x 

**Daisy, Citronella Road,  
Grasmere Gardens  
(Phase 1), Chestfield,  
Whitstable, Kent, CT5**

**OVER 60?**

Secure this property  
for up to **59% less!**

*Wards*  
Helping you move forwards





## Main features

- High specification new build home with integrated appliances
- Fitted wardrobes
- Smart heating controls and 10-year NHBC build warranty
- 2 parking spaces and EV charging point
- Fenced and turfed rear gardens

## Accommodation

### GROUND FLOOR

Hallway

Kitchen: 13'1 x 8'8 (3.99m x 2.64m)

Cloakroom

Lounge / Dining Room : 18'7 x 13'6 (5.67m x 4.12m)

### FIRST FLOOR

Landing

Bedroom 1 : 12'1 x 11'0 (3.69m x 3.36m)

En suite Shower Room

Bedroom 2 : 10'1 x 9'5 (3.08m x 2.87m)

Bedroom 3 : 10'5 x 8'3 (3.18m x 2.52m)

Bathroom

### OUTSIDE

Front Garden

Driveway

Rear Garden

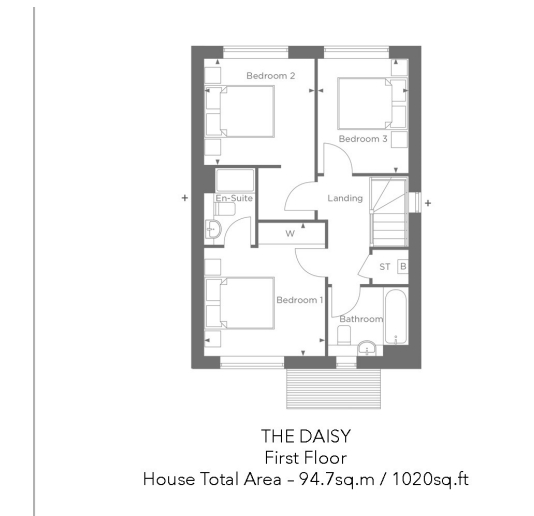
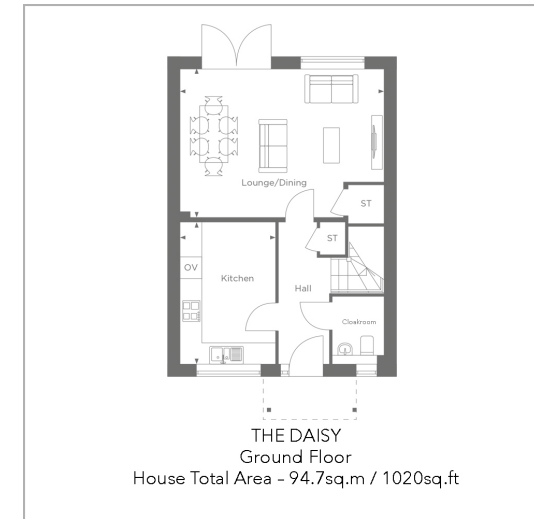

**Call Whitstable - 01227 772272 ■ [wardsofkent.co.uk](http://wardsofkent.co.uk)**

- If buying to let, the energy rating will need to be improved to at least 'E' rating before you can let the property
- Legal advice should be taken to verify fixtures/fittings, planning, alterations and/or lease details
- Appliances & services are untested, dimensions are approximate and floor plans are not to scale
- Through a Homewise Home For Life Plan people aged 60+ can secure this property for up to 59% less, by purchasing a Lifetime Lease.



12033424/20240220/AR/NF