



**Price**  
**£435,000**

**Freehold**

3x  2x  1x 

**Nassella Gardens,  
Grasmere Gardens  
(Phase 1), Chestfield,  
Whitstable, Kent, CT5**

**OVER 60?**

Secure this property  
for up to **59% less!**

*Wards*  
Helping you move forwards





## Main features

- Bespoke design fully fitted kitchen with Bosch integrated appliances
- Fitted wardrobes to the main bedroom
- Contemporary bathroom suites
- Smart Heating controls
- 10-year NHBC warranty for peace of mind

## Accommodation

### GROUND FLOOR

Hallway  
 Kitchen: 13'1 x 8'8 (3.99m x 2.64m)  
 Cloakroom  
 Lounge / Dining: 18'7 x 13'6 (5.67m x 4.12m)

### FIRST FLOOR

Landing  
 Bedroom 1 : 12'1 x 11'0 (3.69m x 3.36m)  
 En suite Shower Room  
 Bedroom 2 : 10'1 x 9'5 (3.08m x 2.87m)  
 Bedroom 3 : 10'5 x 8'3 (3.18m x 2.52m)  
 Bathroom

### OUTSIDE

Allocated Parking Space  
 Front Garden  
 Back Garden

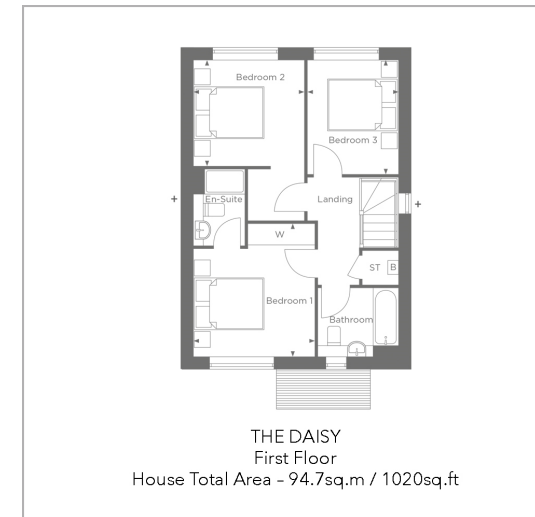
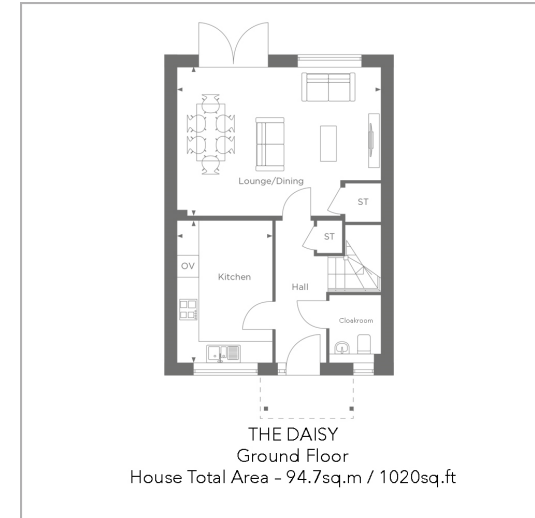

**Call Whitstable - 01227 772272 ■ [wardsof Kent.co.uk](http://wardsof Kent.co.uk)**

- Legal advice should be taken to verify fixtures/fittings, planning, alterations and/or lease details
- Appliances & services are untested, dimensions are approximate and floor plans are not to scale
- Through a Homewise Home For Life Plan people aged 60+ can secure this property for up to 59% less, by purchasing a Lifetime Lease.



12033425/20240306/AR/NF