



**Price**  
**£260,000**

**Freehold**

2x  1x  1x 

**Tay Close, Lordswood,  
Chatham, Kent, ME5**

**OVER 60?**

Secure this property  
for up to **59% less!**

*Wards*  
Helping you move forwards





## Main features

- An excellent property offering good potential for you to add your own personality
- Private rear garden
- Quiet cul-de-sac position
- A short drive to the M2/M20 motorways
- No chain

## Accommodation

### GROUND FLOOR

Entrance Porch

Lounge/Diner : 16'1 x 10'1 (4.91m x 3.08m)

Kitchen : 8'2 x 6'0 (2.49m x 1.83m)

Bedroom 1: 13'1 x 9'2 (3.99m x 2.80m)

Bedroom 2 : 9'6 x 8'8 (2.90m x 2.64m)

Bathroom : 6'0 x 5'8 (1.83m x 1.73m)

### OUTSIDE

Front Garden

Driveway

Rear Garden

### Ground Floor

Approx. 47.1 sq. metres (506.9 sq. feet)

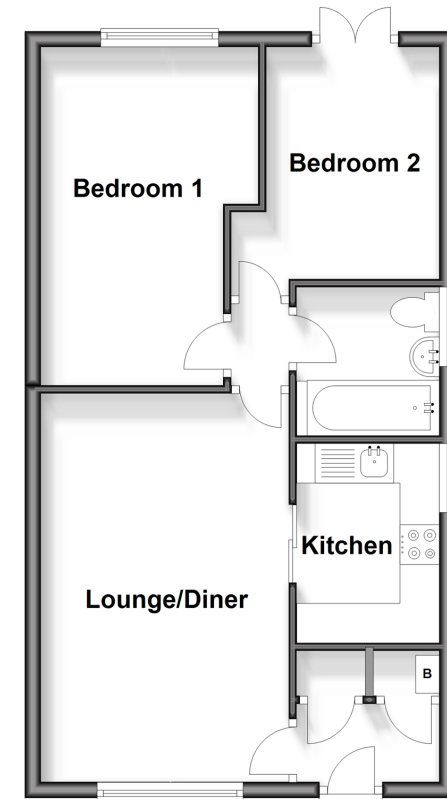

**Call Walderslade - 01634 865661 ■ [wardsof Kent.co.uk](http://wardsof Kent.co.uk)**

- Legal advice should be taken to verify fixtures/fittings, planning, alterations and/or lease details
- Appliances & services are untested, dimensions are approximate and floor plans are not to scale
- Through a Homewise Home For Life Plan people aged 60+ can secure this property for up to 59% less, by purchasing a Lifetime Lease.



12139275/20240412/ML/KG