



Price
£280,000

Freehold

2x  1x  1x 

**Bromley Close,
Chatham, Kent, ME5**

OVER 60?

Secure this property
for up to **59% less!**

Wards
Helping you move forwards



Main features

- A well presented property which is nicely tucked away in a cul-de-sac
- Easy access to amenities
- Corner plot rear garden and walking distance to nearby woodlands
- This home is completely on the flat
- Decorated to a high standard

Accommodation

Hallway

Bedroom 1 : 15'5 x 10'2 (4.70m x 3.10m)

Bedroom 2: 9'8 x 7'8 (2.95m x 2.34m)

Lounge/Diner : 16'7 x 10'1 (5.06m x 3.08m)

Shower Room: 6'5 x 5'4 (1.96m x 1.63m)

Kitchen/Breakfast Room : 11'7 x 11'6 (3.53m x 3.51m)

OUTSIDE

Front Garden

Corner plot rear garden

Ground Floor

Approx. 62.8 sq. metres (675.5 sq. feet)

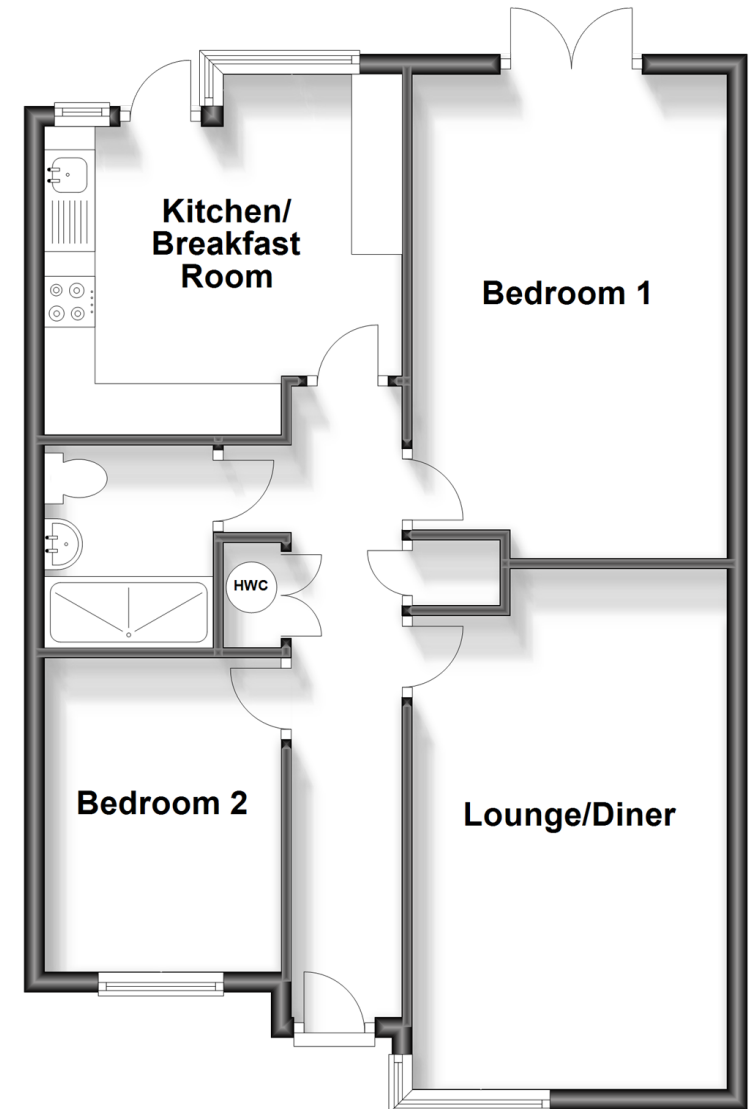

Call Walderslade - 01634 865661 ■ wardsof Kent.co.uk

- Legal advice should be taken to verify fixtures/fittings, planning, alterations and/or lease details
- Appliances & services are untested, dimensions are approximate and floor plans are not to scale
- Through a Homewise Home For Life Plan people aged 60+ can secure this property for up to 59% less, by purchasing a Lifetime Lease.



12143839/20240212/ML/KG