



Price
£375,000

Freehold

2x  1x  2x 

**The Green, Bearsted,
Maidstone, Kent, ME14**

OVER 60?

Secure this property
for up to **59% less!**



Video Tour available

Wards
Helping you move forwards



Main features

- Charming character cottage over looking the village green
- Includes highly sought after off road parking to the rear
- Sizeable rear garden with handy rear access
- Central village location near shops, pubs and restaurants
- Prominent position for village life

Accommodation

GROUND FLOOR

Entrance Porch

Lounge: 12'7 x 10'6 (3.84m x 3.20m)

Dining Area: 12'5 x 10'6 (3.79m x 3.20m)

Kitchen: 13'4 x 6'10 (4.07m x 2.08m)

FIRST FLOOR

Landing

Bedroom 1: 12'7 x 10'6 (3.84m x 3.20m)

Bedroom 2: 12'5 x 5'9 (3.79m x 1.75m)

Bathroom: 13'7 x 6'8 (4.14m x 2.03m)

OUTSIDE

Front and Rear Gardens

Off Road Parking

Ground Floor

Approx. 34.8 sq. metres (374.7 sq. feet)

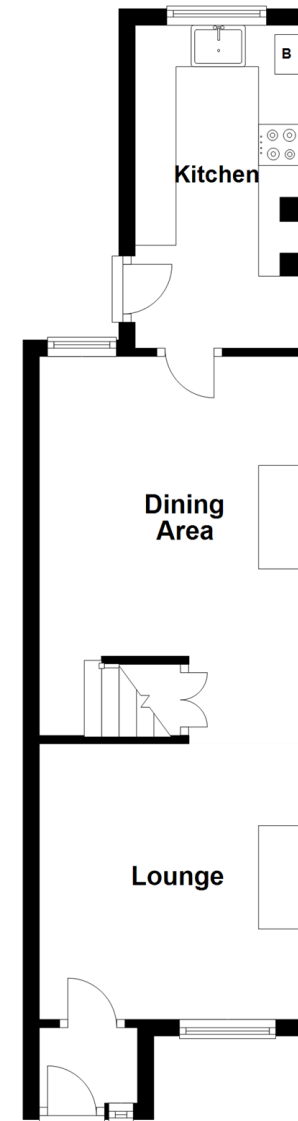

First Floor

Approx. 33.6 sq. metres (361.6 sq. feet)

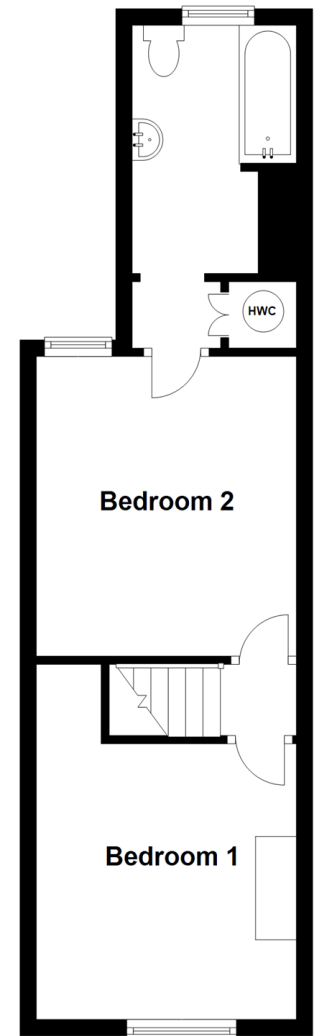

Call Bearsted - 01622 730955 ■ wardsofkent.co.uk

- Legal advice should be taken to verify fixtures/fittings, planning, alterations and/or lease details
- Appliances & services are untested, dimensions are approximate and floor plans are not to scale
- Through a Homewise Home For Life Plan people aged 60+ can secure this property for up to 59% less, by purchasing a Lifetime Lease.