



Price
£800,000

Freehold

4x  2x  2x 

**Weaving Street,
Weaving, Maidstone,
Kent, ME14**

OVER 60?

You could get up to
59% off the price!*



Video Tour available

Wards
Helping you move forwards



Main features

- Stunning chalet style house on popular Weaving development
- Spacious, modern accommodation throughout
- Beautiful kitchen to rear overlooking redesigned and landscaped garden
- Garage, parking and pretty garden to front
- Easy access to local school and amenities yet positioned in a quiet location

Accommodation

GROUND FLOOR

Entrance Hall

Cloakroom

Kitchen: 16'2 x 13'5 (4.93m x 4.09m)

Office/Dining Room: 12'9 x 12'0 (3.89m x 3.66m)

Lounge: 19'7 x 11'11 (5.97m x 3.63m)

Sun Room: 18'5 x 8'10 (5.62m x 2.69m)

FIRST FLOOR

Landing

Bedroom 1: 14'6 x 14'4 (4.42m x 4.37m)

En-Suite Shower Room: 9'1 x 7'11 (2.77m x 2.41m)

Bedroom 2: 9'5 x 8'10 (2.87m x 2.69m)

Bedroom 3: 12'8 x 8'4 (3.86m x 2.54m)

Bedroom 4: 10'1 x 7'2 (3.08m x 2.19m)

Bathroom: 10'11 x 7'2 (3.33m x 2.19m)

OUTSIDE

Front & Rear Gardens

Garage & Driveway

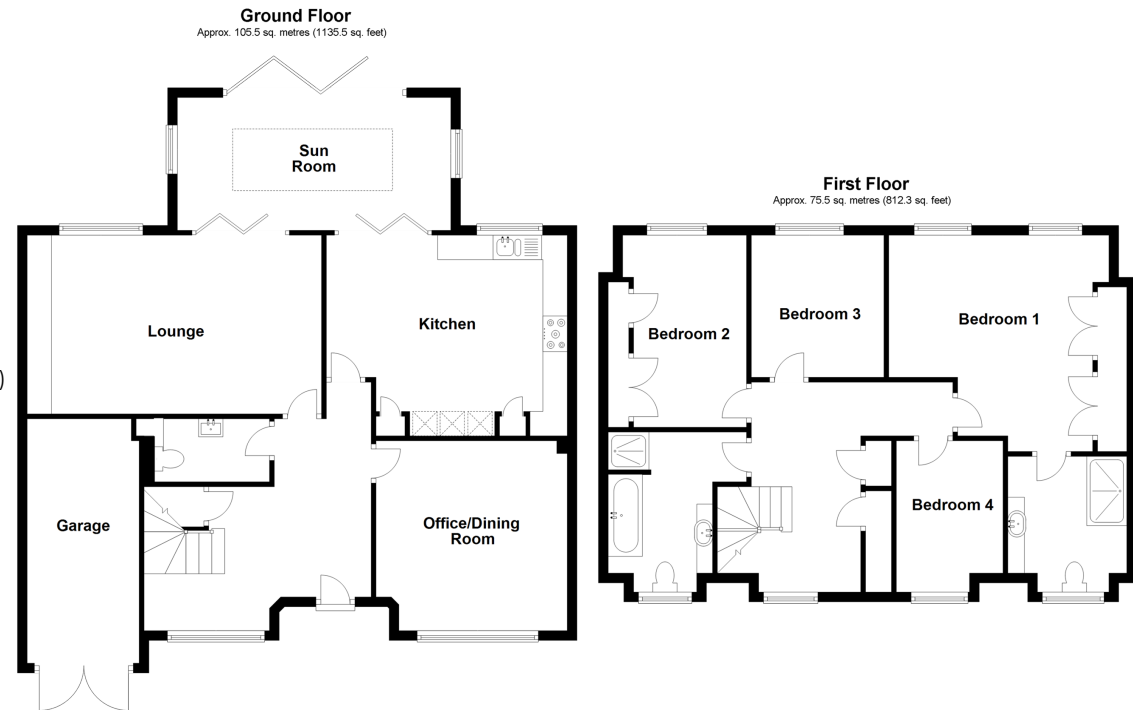

Call Bearsted - 01622 730955 ■ wardsofkent.co.uk

- Legal advice should be taken to verify fixtures/fittings, planning, alterations and/or lease details
- Our Homewise partnership offer a 'Home for Life' plan to buyers over 60, granting a lifetime lease for your protection and reducing the purchase price by up to 59%

- Appliances & services are untested, dimensions are approximate and floor plans are not to scale