



**Price**  
**£320,000**

**Freehold**

2x  1x  1x 

**Bushy Grove,  
Kingswood, Maidstone,  
Kent, ME17**

**OVER 60?**

Secure this property  
for up to **59% less!**

*Wards*  
Helping you move forwards





## Main features

- Improved home situated in a popular village location
- Double glazed conservatory with views and access over a landscaped rear garden and garage
- Attractive shower room
- No chain involved
- Modern fitted kitchen

## Accommodation

### GROUND FLOOR

Entrance Hall

Lounge: 17'0 x 10'7 (5.19m x 3.23m)

Conservatory: 7'10 x 7'5 (2.39m x 2.26m)

Kitchen: 9'8 x 9'2 (2.95m x 2.80m)

Shower Room: 6'6 x 5'4 (1.98m x 1.63m)

Bedroom 1: 13'10 x 10'8 (4.22m x 3.25m)

Bedroom 2: 10'7 x 9'9 (3.23m x 2.97m)

### OUTSIDE

Garage and Driveway

Front and Rear Gardens

Shed

### Ground Floor

Approx. 66.5 sq. metres (715.4 sq. feet)

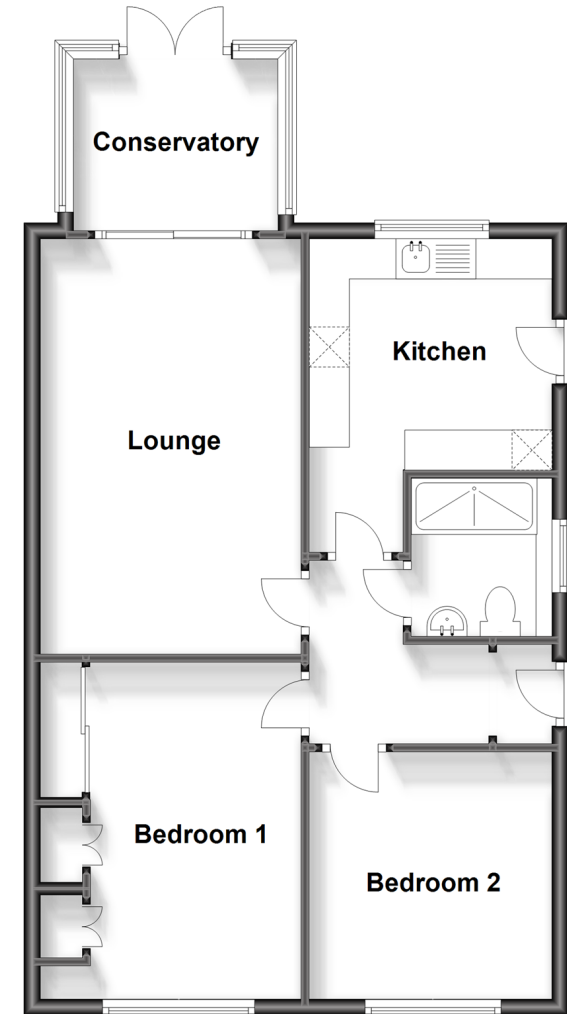

**Call Bearsted - 01622 730955 ■ [wardsofkent.co.uk](http://wardsofkent.co.uk)**

- Legal advice should be taken to verify fixtures/fittings, planning, alterations and/or lease details
- Appliances & services are untested, dimensions are approximate and floor plans are not to scale
- Through a Homewise Home For Life Plan people aged 60+ can secure this property for up to 59% less, by purchasing a Lifetime Lease.



12328418 / 20230622 / RM / JW