



Price
£625,000

Freehold

3x  2x  2x 

Laxton Drive, Chart
Sutton, Maidstone, Kent,
ME17

OVER 60?

Secure this property
for up to **59% less!**

Wards
Helping you move forwards



Main features

- Ample parking with a large drive and garage
- Set in a quiet cul-de-sac location
- Short distance from local schools, shops and amenities
- Thoughtfully presented with modern kitchen
- Beautiful landscape garden with a tranquil pond and summer house

Accommodation

GROUND FLOOR

Entrance Hall

Lounge: 13'7 x 11'9 (4.14m x 3.58m)

Kitchen: 18'5 x 11'5 (5.62m x 3.48m)

Conservatory: 25'1 x 12'3 (7.65m x 3.74m)

Bedroom 1: 12'2 x 9'9 (3.71m x 2.97m)

En suite Shower Room

Toilet

Dressing Area: 11'8 x 8'0 (3.56m x 2.44m)

Bedroom 2: 12'9 x 10'0 (3.89m x 3.05m)

Bathroom

Bedroom 3/Office: 9'9 x 7'9 (2.97m x 2.36m)

OUTSIDE

Front and Rear Gardens

Driveway

Garage and Car Port

Ground Floor
Approx. 142.6 sq. metres (1535.3 sq. feet)

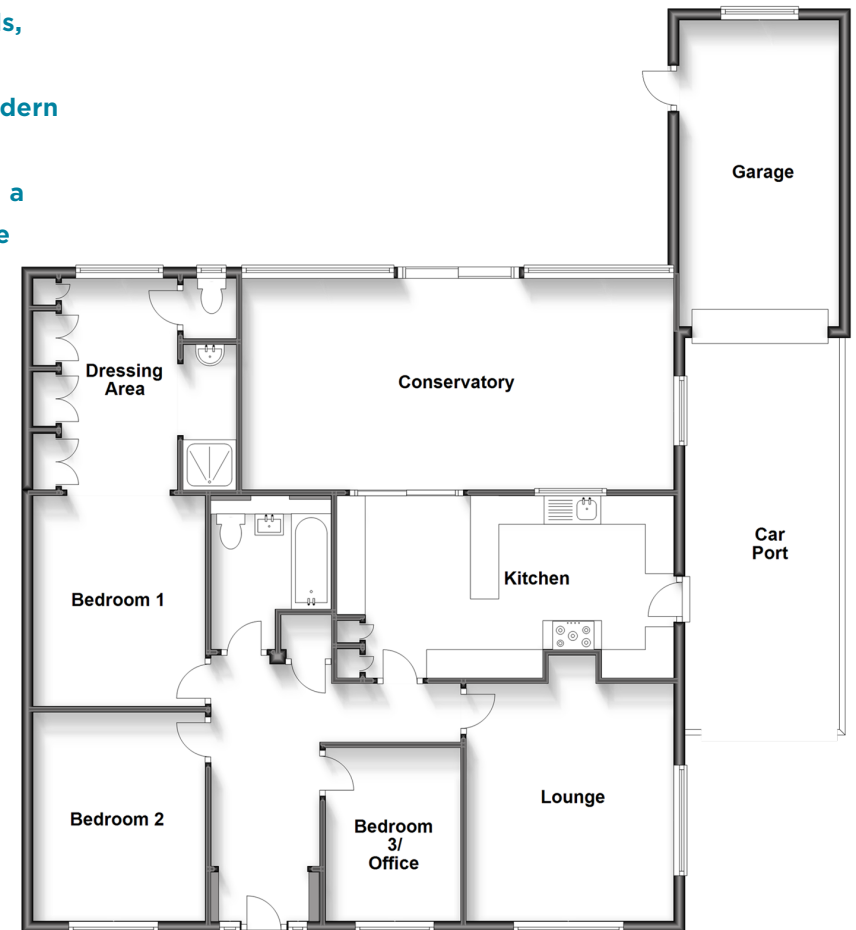

Call Headcorn - 01622 890435 ■ wardsof Kent.co.uk

- Legal advice should be taken to verify fixtures/fittings, planning, alterations and/or lease details
- Appliances & services are untested, dimensions are approximate and floor plans are not to scale
- Through a Homewise Home For Life Plan people aged 60+ can secure this property for up to 59% less, by purchasing a Lifetime Lease.



12719552/20230804/HC/TB