



Guide Price
£80,000

1x  1x  1x 

**Lime Grove, Woodlands
Park, Biddenden,
Ashford, Kent, TN27**

Wards
Helping you move forwards



Main features

- Neatly presented with neutral decor throughout
- Residential
- Quiet location with a fantastic friendly community
- Driveway
- Short distance from Headcorn high street

Accommodation

GROUND FLOOR

Entrance Hall
 Lounge/Diner: 24'0 x 9'7 (7.32m x 2.92m)
 Bathroom
 Kitchen: 8'4 x 7'1 (2.54m x 2.16m)
 Hallway
 Bedroom: 10'0 x 7'1 (3.05m x 2.16m)

OUTSIDE

Front and Rear Gardens
 Driveway

Ground Floor

Approx. 42.8 sq. metres (460.5 sq. feet)

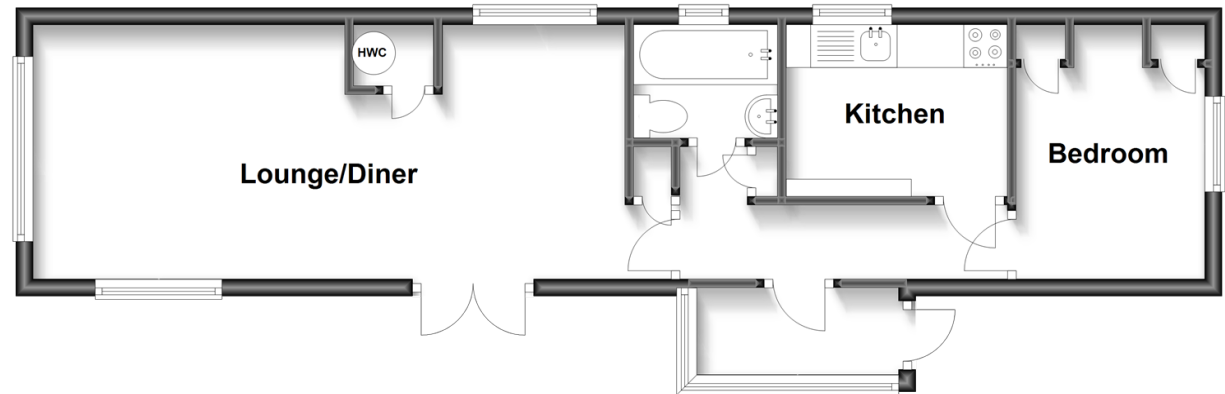

Call Headcorn - 01622 890435 ■ wardsof Kent.co.uk

- If buying to let, the energy rating will need to be improved to at least 'E' rating before you can let the property
- Appliances & services are untested, dimensions are approximate and floor plans are not to scale

■ Legal advice should be taken to verify fixtures/fittings, planning, alterations and/or lease details



12721681/20231219/HS1/TB