



Price
£299,999

Freehold

2x  1x  2x 

**Charlesford Avenue,
Kingswood, Maidstone,
Kent, ME17**

Wards
Helping you move forwards



Main features

- Front and rear driveway with a single garage
- Conservatory leading out to a sunny garden
- Spacious throughout with room to entertain
- Walking distance to local shops
- Set in a quiet semi-rural location

Accommodation

GROUND FLOOR

Entrance Hall

Lounge: 18'0 x 12'5 (5.49m x 3.79m)

Kitchen: 12'9 x 9'2 (3.89m x 2.80m)

Conservatory: 9'6 x 8'3 (2.90m x 2.52m)

Shower Room

Bedroom 1: 16'0 x 11'0 (4.88m x 3.36m)

Bedroom 2: 10'6 x 10'6 (3.20m x 3.20m)

OUTSIDE

Front and Rear Gardens

Driveway

Garage

Ground Floor

Approx. 76.1 sq. metres (819.0 sq. feet)

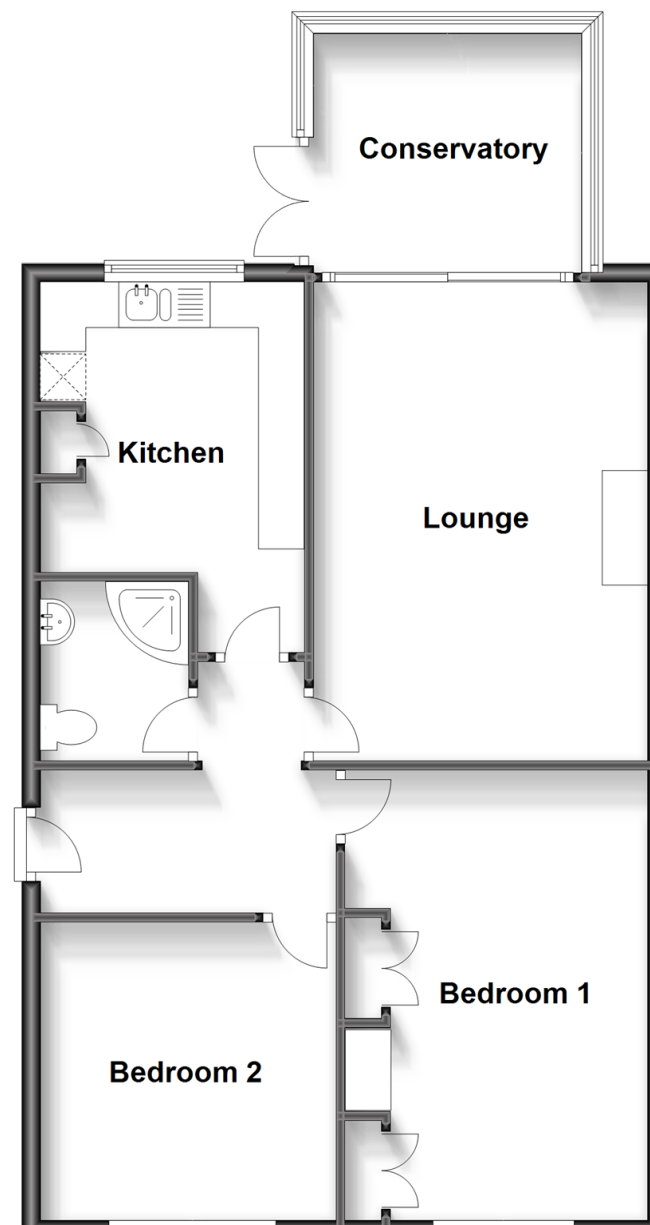

Call Headcorn - 01622 890435 ■ wardsofken.co.uk

- Legal advice should be taken to verify fixtures/fittings, planning, alterations and/or lease details
- Appliances & services are untested, dimensions are approximate and floor plans are not to scale



12721715/20230726/TB/TB