



Price
£440,000

Freehold

2x  2x  1x 

**Stone Street, Lympne,
Hythe, Kent, CT21**

OVER 60?

Secure this property
for up to **59% less!**

Wards
Helping you move forwards

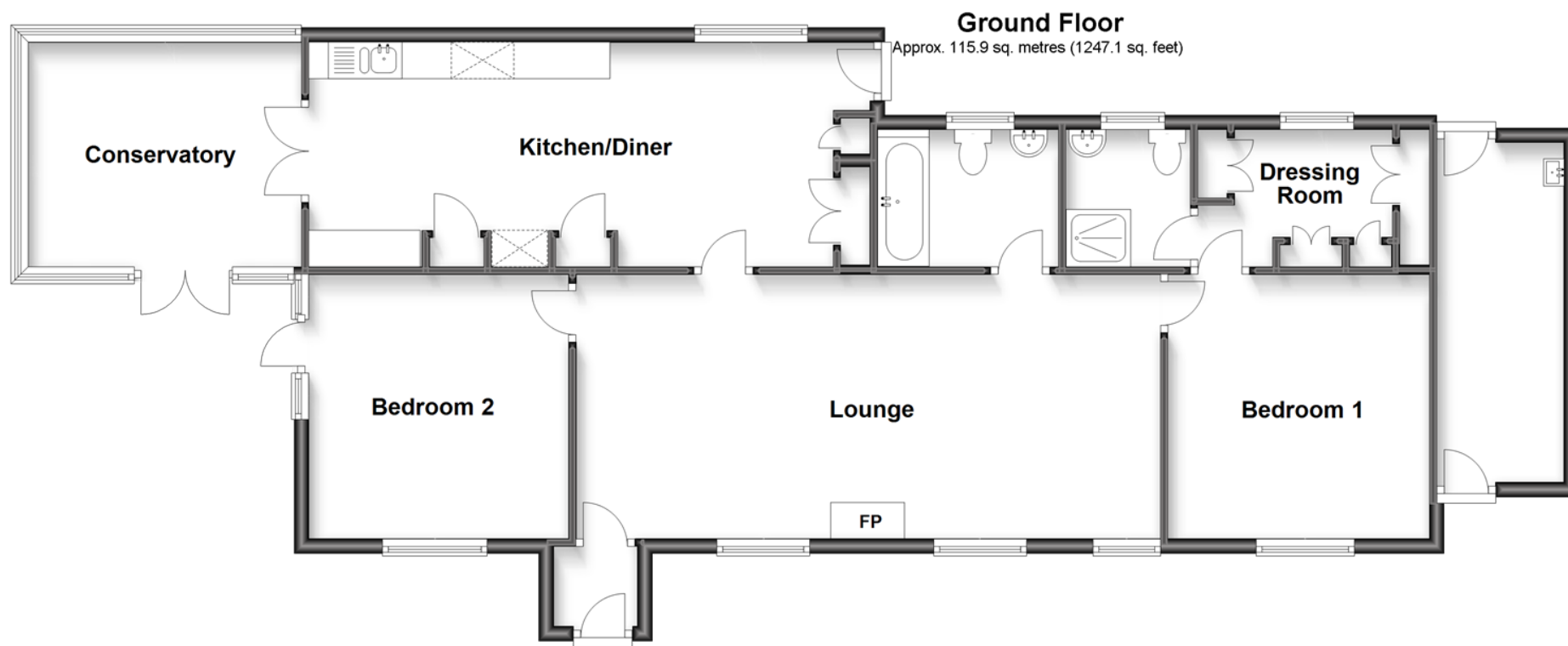

Accommodation

GROUND FLOOR

Porch
 Kitchen/Diner: 25'3 x 10'0 (7.70m x 3.05m)
 Conservatory: 12'4 x 9'0 (3.76m x 2.75m)
 Lounge: 26'1 x 11'9 (7.96m x 3.58m)
 Bedroom 1: 11'8 x 11'5 (3.56m x 3.48m)
 Dressing Room: 8'3 x 5'10 (2.52m x 1.78m)
 En-Suite Shower Room: 5'10 x 5'5 (1.78m x 1.65m)
 Bedroom 2: 11'8 x 11'6 (3.56m x 3.51m)
 Bathroom: 8'1 x 5'10 (2.47m x 1.78m)

OUTSIDE

Off Road Parking
 Front & Rear Gardens
 Lean-To



Main features

- No onward chain
- Ragstone detached cottage, formerly the toll cottage of Lympne
- Off road parking for 3 cars
- Both bedrooms are doubles
- Dressing room and en-suite shower room to bedroom 1
- Large kitchen/diner, conservatory



Nearest Schools

Primary Schools: Lympne Primary 0.6 miles, Sellindge Primary 2.8 miles

Secondary Schools: Brockhill Park Performing Arts College 3.5 miles, The Harvey Grammar School 6.8 miles



Transport Information

Train Stations: Westenhanger 1.3 miles, Sandling 3.0 miles, Folkestone West High Speed Link 6.9 miles



Address

Stone Street, Lympne, Hythe, Kent, CT21



Directions

For directions to this property please contact us.



Wards
Helping you move forwards

Call Hythe Branch 01303 267473 ■ wardsofkent.co.uk



- Legal advice should be taken to verify fixtures/fittings, planning, alterations and/or lease details
- Appliances & services are untested, dimensions are approximate and floor plans are not to scale
- Through a Homewise Home For Life Plan people aged 60+ can secure this property for up to 59% less, by purchasing a Lifetime Lease.



12821284/20230511/MB/MB