



Price
£210,000

Leasehold

1x  1x  1x 

**The Maltings, High
Street, Hythe, Kent,
CT21**

OVER 60?

Secure this property
for up to **59% less!**

Wards
Helping you move forwards



Main features

- Stunning second floor apartment, allocated parking and long lease
- Large walk-in wardrobe, lift to all floors
- Grade II listed building
- Just off the High Street so perfect for someone who doesn't drive
- Short walk to supermarkets, shops and restaurants

Accommodation

SECOND FLOOR

Entrance Hall

Bathroom

Lounge: 15'3 x 12'3 (4.65m x 3.74m)

Kitchen: 11'10 x 6'3 (3.61m x 1.91m)

Bedroom : 13'3 (4.04m) narrowing to 9'1 (2.77m) x 10'5 (3.18m)

Walk-In Wardrobe: 5'3 x 4'4 (1.60m x 1.32m)

OUTSIDE

Allocated Parking

Second Floor

Approx. 49.8 sq. metres (536.5 sq. feet)

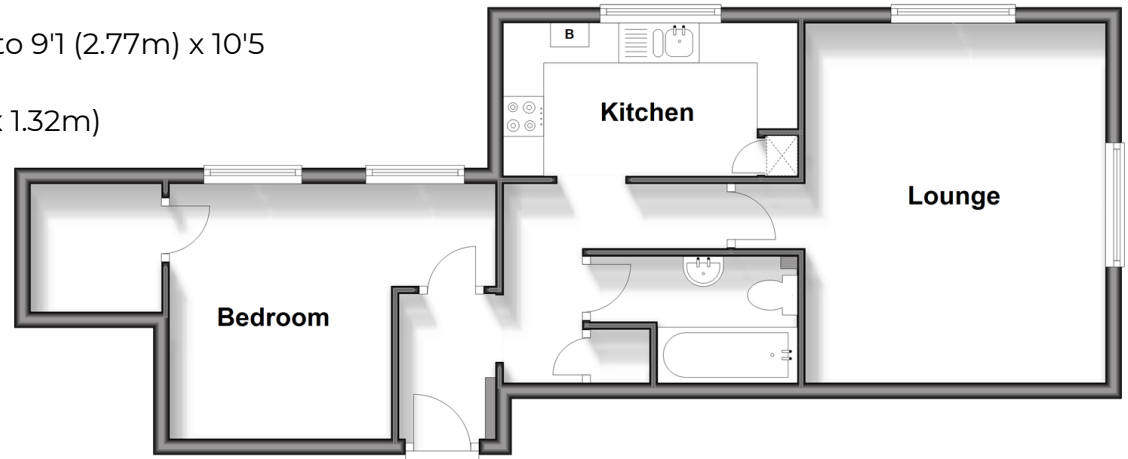

Call Hythe - 01303 267473 ■ wardsof Kent.co.uk

■ Legal advice should be taken to verify fixtures/fittings, planning, alterations and/or lease details
 ■ Through a Homewise Home For Life Plan people aged 60+ can secure this property for up to 59% less, by purchasing a Lifetime Lease.

■ Appliances & services are untested, dimensions are approximate and floor plans are not to scale