



Price
£345,000

Freehold

2x  1x  1x 

**Ethelburga Drive,
Lyminge, Folkestone,
Kent, CT18**



Video Tour available

Wards
Helping you move forwards



Main features

- This stunning home is ready to move into, large rear garden
- The current owners have extensively refurbished to a very high standard
- An amazing kitchen with quartz work tops, ideal for gatherings
- Brass handles, Neff appliances and wine cooler
- Beautiful bathroom, garage en-bloc

Accommodation

GROUND FLOOR

Entrance Hallway

Lounge : 13'1 x 8'8 (3.99m x 2.64m)

Bedroom 1 : 12'2 x 7'6 (3.71m x 2.29m)

Bedroom 2 : 10'5 x 8'10 (3.18m x 2.69m)

Kitchen/Diner : 19'7 x 9'6 (5.97m x 2.90m)

Conservatory: 18'2 x 7'7 (5.54m x 2.31m)

Bathroom : 7'1 x 5'3 (2.16m x 1.60m)

OUTSIDE

Front Garden

Rear Garden

Garage En-bloc

Ground Floor

Approx. 71.8 sq. metres (772.7 sq. feet)

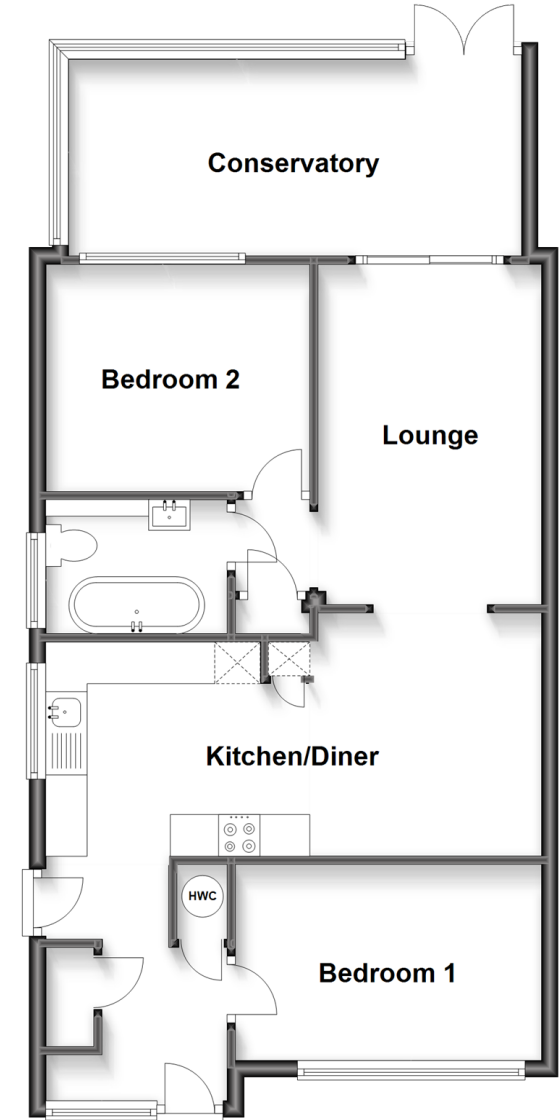

Call Hythe - 01303 267473 ■ wardsof Kent.co.uk

- Legal advice should be taken to verify fixtures/fittings, planning, alterations and/or lease details
- Appliances & services are untested, dimensions are approximate and floor plans are not to scale



12824313/20230217/MB/DC