



**OVER 60?**

Secure this property  
for up to **59% less!**



Video Tour available

**Price**

**£220,000**

**Leasehold**

2x 1x 1x

**Lukin House, Romney  
Way, Hythe, Kent, CT21**

**Wards**  
Helping you move forwards





## Main features

- This lovely first floor apartment is a short walk away from the canal
- Large lounge / diner
- Good sized kitchen
- Gas central heating, modern shower room
- No onward chain
- Close to local shops and main bus route, short drive to town centre

## Accommodation

### FIRST FLOOR

Entrance Hall

Kitchen: 10'9 x 8'3 (3.28m x 2.52m)

Lounge/Diner: 23'1 x 11'4 (7.04m x 3.46m)

Bedroom 1: 12'8 x 11'1 (3.86m x 3.38m)

Bedroom 2: 9'2 x 8'1 (2.80m x 2.47m)

Shower Room

### First Floor

Approx. 71.2 sq. metres (766.6 sq. feet)

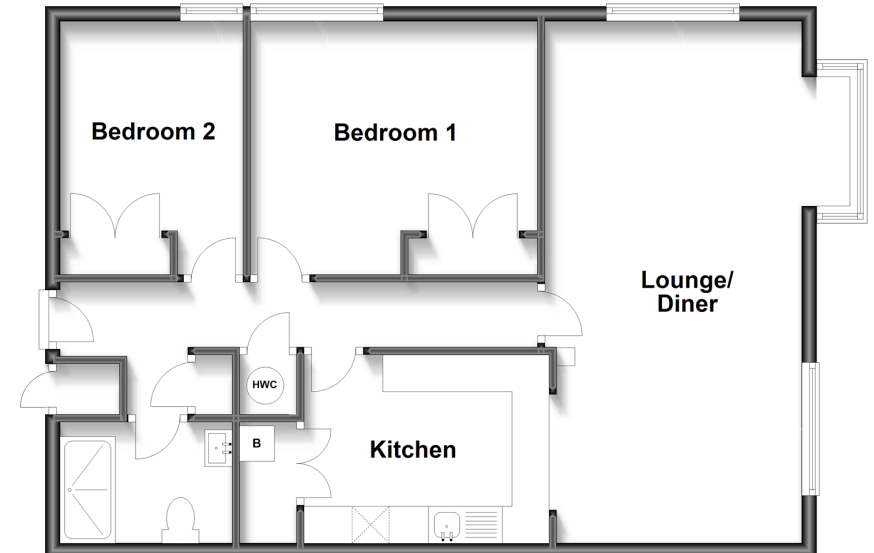

**Call Hythe - 01303 267473 ■ [wardsof Kent.co.uk](http://wardsof Kent.co.uk)**

- Legal advice should be taken to verify fixtures/fittings, planning, alterations and/or lease details
- Appliances & services are untested, dimensions are approximate and floor plans are not to scale
- Through a Homewise Home For Life Plan people aged 60+ can secure this property for up to 59% less, by purchasing a Lifetime Lease.



12824420/20230321/MEL/MB